

DWG No.

CA/90/1100---A

TITLE 1

CA/90/1100

TITLE 2

BRACKET



In association with Skyline Brand

SOR NO.	CA/90/1100
LINE NO.	-
PROJECT:	CANOPY
CUST REF:	SKYLINE
SP REF NO.	-

STAGE	DD/MM/YY	INITIALS
CUT		
PUNCH		
BRAKE		
WELD		

FOR PART QUANTITIES, AND REQUIRED FINISH, PLEASE REFER TO WORKS ORDER CA/90/1100 ACCOMPANYING THIS DRAWING

PARTS REQUIRING PPC FINISHES WILL REQUIRE HANGING HOLES, UNLESS SPECIFIED, HANGING HOLES WILL NOT BE POSITIONED WITHIN A 'SHOW' FACE (SHOW FACES INDICATED BY AN ASTERISK "\*\*")

PLEASE NOTE PPC PARTS MAY REQUIRE A HANGING HOLE IN A FACE TO ENABLE PRODUCT TO BE HUNG VERTICALLY THROUGH PPC PLANT

Copyright © 2017 all rights reserved, this drawing is the property of Alumasc Exterior Building Products.

UNLESS OTHERWISE SPECIFIED: DIMENSIONS ARE IN MILLIMETERS

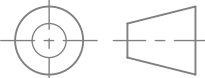

PROJECTION: THIRD ANGLE

DATE:	DESCRIPTION	REV
APPROVED: -	APRV DATE: -	
MATERIAL: 1050A-H14	WEIGHT (KG): 2702.9	
TITLE 1: CA/90/1100		REV.
TITLE 2: BRACKET		A
DRAWN: JC	DATE: 04/02/2021	
SCALE: 1:10 @ A3	SHEET: 1 OF 1	

DWG No.

CA/90/1100---A

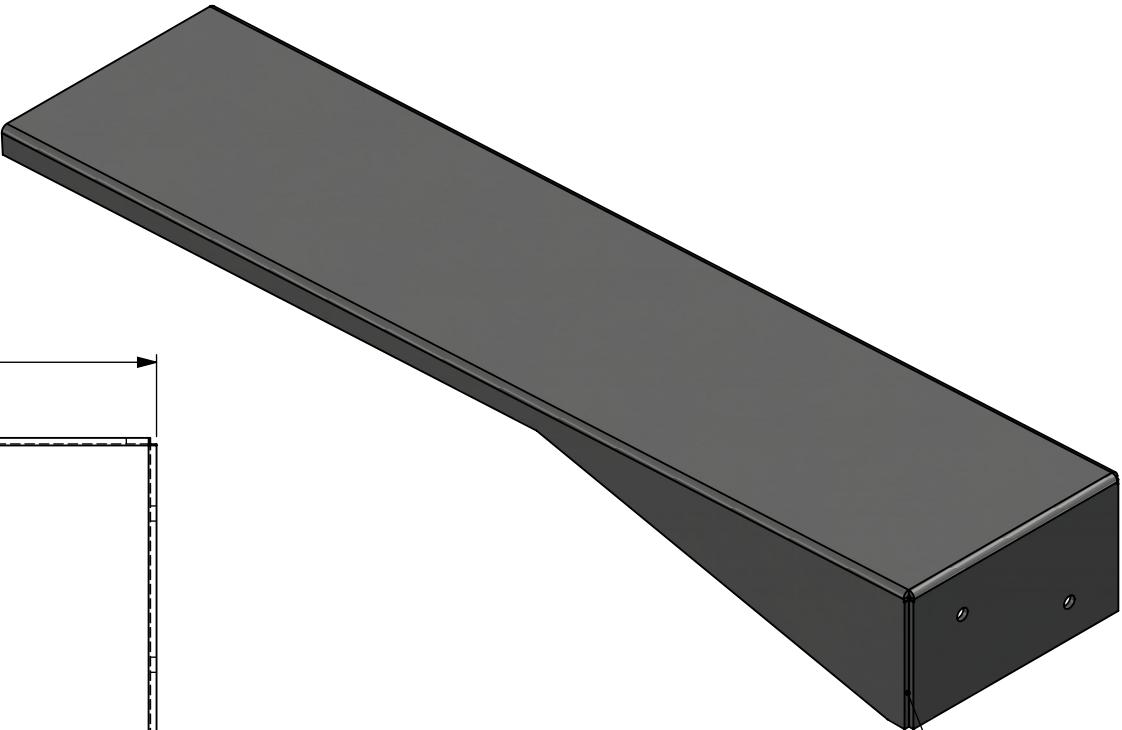

WELD (2)  
CORNERS  
INSIDE

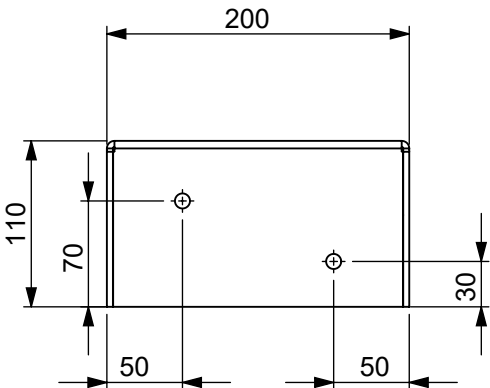
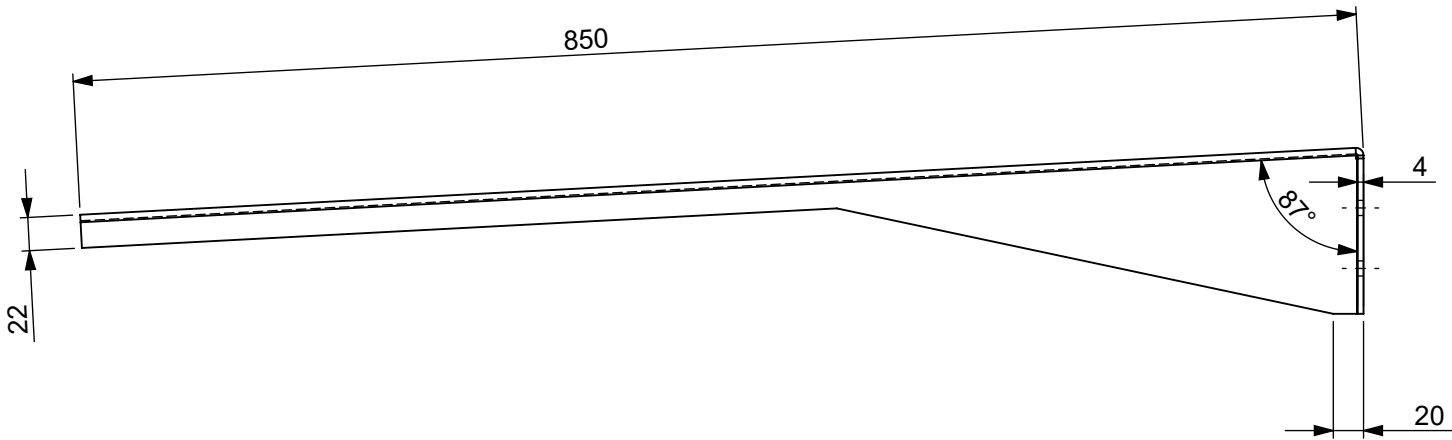
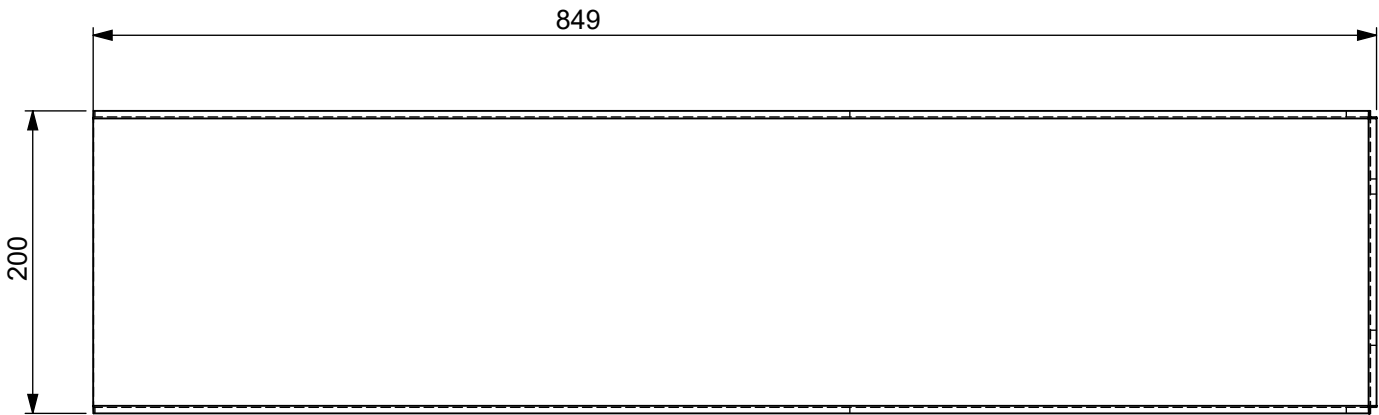

TOLERANCES	
LINEAR +/-	1mm
ANGULAR +/-	1.0°

ITEM NO.	PART/PUNCH I.D	MATERIAL GRADE	Material Thickness	QTY.
1	CA-90-1100-1M BRACKET	1050A-H14	4	-
		1050A-H14		-

CUSTOMER'S APPROVAL

FULL NAME DD/MM/YYYY SIGNATURE

Designers, including but not limited to, Engineers and Architects, must satisfy themselves in respect of the adequacy of the design provided by Alumasc Water Management Solutions ("Alumasc"). It is the Designer's responsibility to ensure that the data has been correctly interpreted. Alumasc accepts no liability for inadequate or inaccurate designs based on limited or false information supplied by the Designer or misinterpretation of the data supplied. For the avoidance of doubt, designs provided by Alumasc prior to an order being placed are for illustrative purposes only and should not be relied upon save for at the Designer's own risk. Drawings issued by Alumasc in respect of an order after that order has been placed shall be fit for the purpose for which it was created.



In association with Skyline Brand

SOR NO.	CA/90/1100/1M
LINE NO.	-
PROJECT:	CANOPY
CUST REF:	AWMS
SP REF NO.	SKYLINE

STAGE	DD/MM/YY	INITIALS
CUT		
PUNCH		
BRAKE		
WELD		

FOR PART QUANTITIES, AND REQUIRED FINISH, PLEASE REFER TO WORKS ORDER CA/90/1100/1M ACCOMPANYING THIS DRAWING

PARTS REQUIRING PPC FINISHES WILL REQUIRE HANGING HOLES, UNLESS SPECIFIED, HANGING HOLES WILL NOT BE POSITIONED WITHIN A 'SHOW' FACE (SHOW FACES INDICATED BY AN ASTERISK "\*\*")

PLEASE NOTE PPC PARTS MAY REQUIRE A HANGING HOLE IN A FACE TO ENABLE PRODUCT TO BE HUNG VERTICALLY THROUGH PPC PLANT

Copyright © 2017 all rights reserved, this drawing is the property of Alumasc Exterior Building Products.

UNLESS OTHERWISE SPECIFIED: DIMENSIONS ARE IN MILLIMETERS

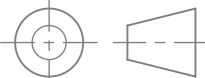

PROJECTION: THIRD ANGLE

DATE:	DESCRIPTION	REV
APPROVED: -	APRV DATE: -	
MATERIAL: SEE DRAWING	WEIGHT (KG): 17353.8	
TITLE 1: CANOPY	TITLE 2: 1M	REV. A
DRAWN: JC	DATE: 04/02/2021	
SCALE: 1:10 @ A3	SHEET: 1 OF 1	

DWG No. CA/90/1100/1M---A

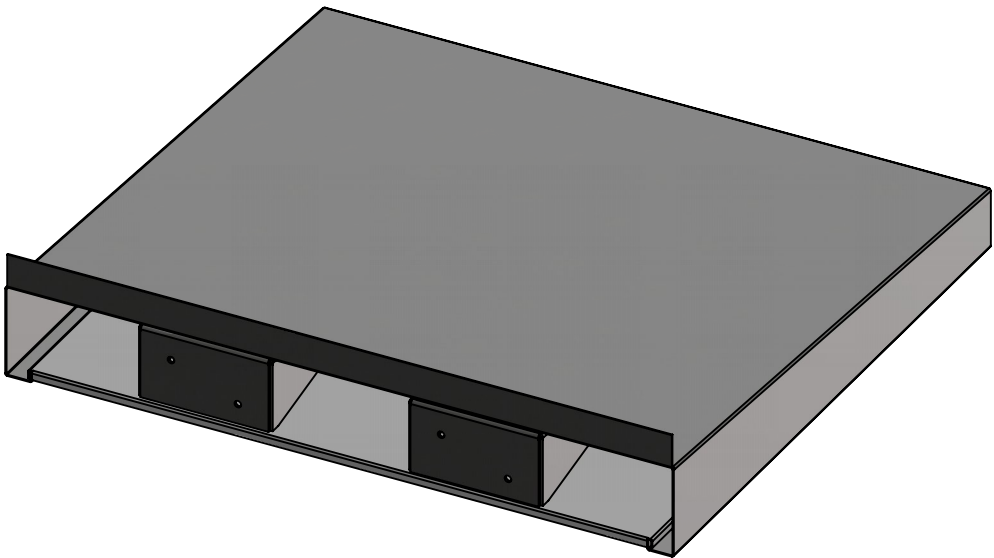
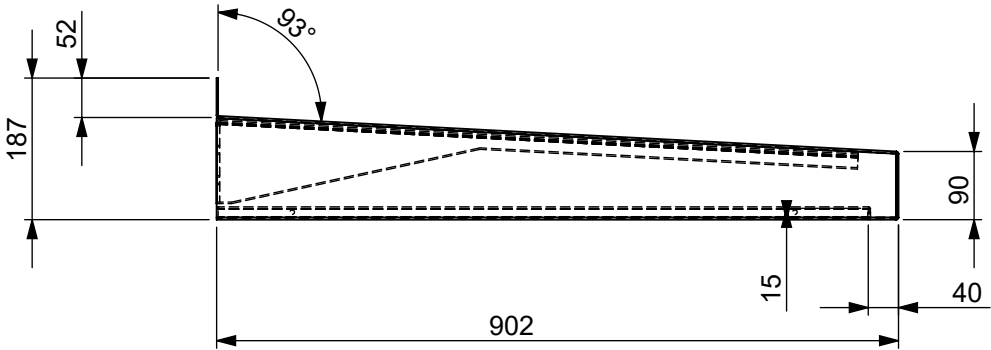
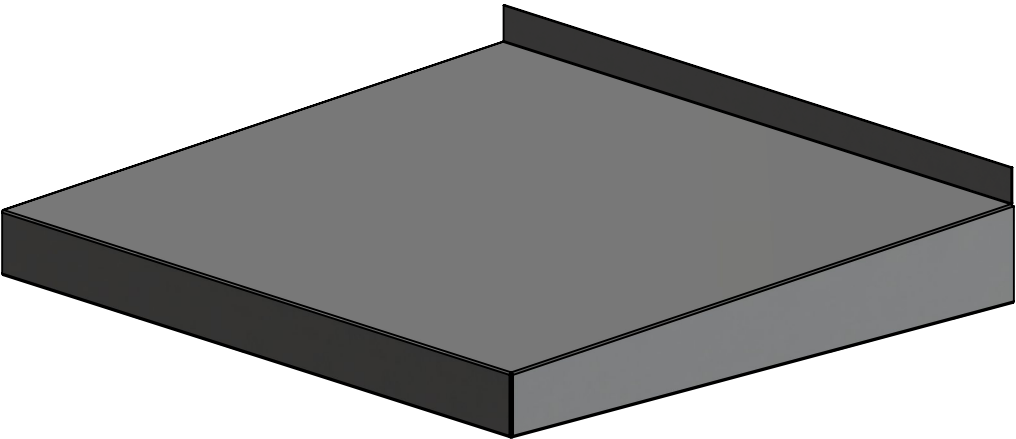
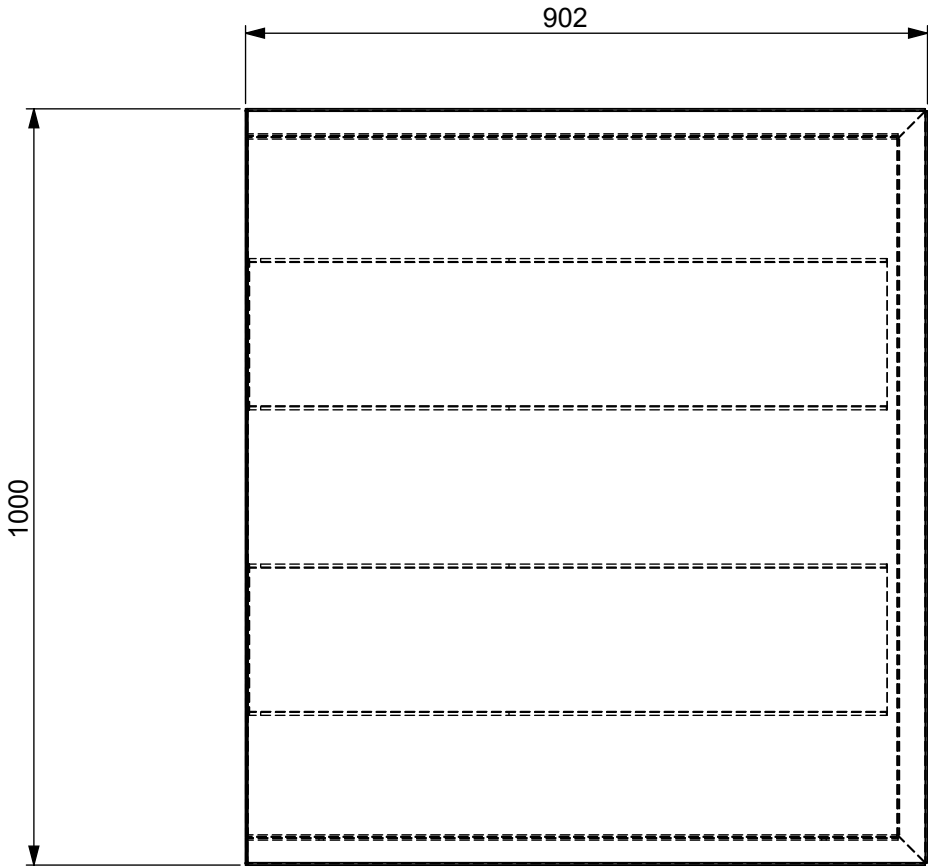

CUSTOMER'S APPROVAL

FULL NAME DD/MM/YYYY SIGNATURE

TOLERANCES	
LINEAR +/-	1mm
ANGULAR +/-	1.0°

ITEM NO.	PART/PUNCH I.D	MATERIAL GRADE	Material Thickness	QTY.
1	CA-90-1100-1M HOOD	1050A-H14	2	1
2	CA-90-1100-1M SOFFIT	1050A-H14	2	1
3	CA-90-1100-1M BRACKET	1050A-H14	4	2

Designers, including but not limited to, Engineers and Architects, must satisfy themselves in respect of the adequacy of the design provided by Alumasc Water Management Solutions ("Alumasc"). It is the Designer's responsibility to ensure that the data has been correctly interpreted. Alumasc accepts no liability for inadequate or inaccurate designs based on limited or false information supplied by the Designer or misinterpretation of the data supplied. For the avoidance of doubt, designs provided by Alumasc prior to an order being placed are for illustrative purposes only and should not be relied upon save for at the Designer's own risk. Drawings issued by Alumasc in respect of an order after that order has been placed shall be fit for the purpose for which it was created.

DWG No.

CA/90/1100/1M---A

TITLE 1

CA/90/1100/1M

TITLE 2

CANOPY HOOD



In association with Skyline Brand

SOR NO.	CA/90/1100/1M
LINE NO.	-
PROJECT:	CANOPY
CUST REF:	SKYLINE
SP REF NO.	000000

STAGE	DD/MM/YY	INITIALS
CUT		
PUNCH		
BRAKE		
WELD		

FOR PART QUANTITIES, AND REQUIRED FINISH, PLEASE REFER TO WORKS ORDER CA/90/1100/1M ACCOMPANYING THIS DRAWING

PARTS REQUIRING PPC FINISHES WILL REQUIRE HANGING HOLES, UNLESS SPECIFIED, HANGING HOLES WILL NOT BE POSITIONED WITHIN A 'SHOW' FACE (SHOW FACES INDICATED BY AN ASTERISK "\*\*")

PLEASE NOTE PPC PARTS MAY REQUIRE A HANGING HOLE IN A FACE TO ENABLE PRODUCT TO BE HUNG VERTICALLY THROUGH PPC PLANT

Copyright © 2017 all rights reserved, this drawing is the property of Alumasc Exterior Building Products.

UNLESS OTHERWISE SPECIFIED: DIMENSIONS ARE IN MILLIMETERS

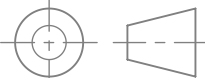

PROJECTION: THIRD ANGLE

DATE:	DESCRIPTION	REV
APPROVED: -	APRV DATE: -	
MATERIAL: 1050A-H14	WEIGHT (KG): 7431.3	
TITLE 1: CA/90/1100/1M	TITLE 2: CANOPY HOOD	REV. <b>A</b>
DRAWN: JC	DATE: 04/02/2021	
SCALE: 1:10 @ A3	SHEET: 1 OF 1	

DWG No.

CA/90/1100/1M---A

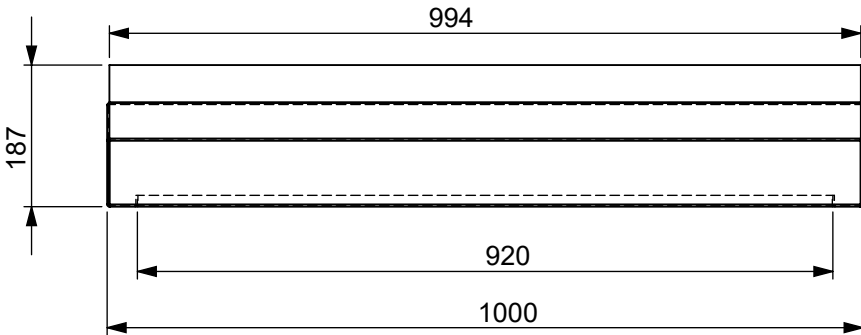
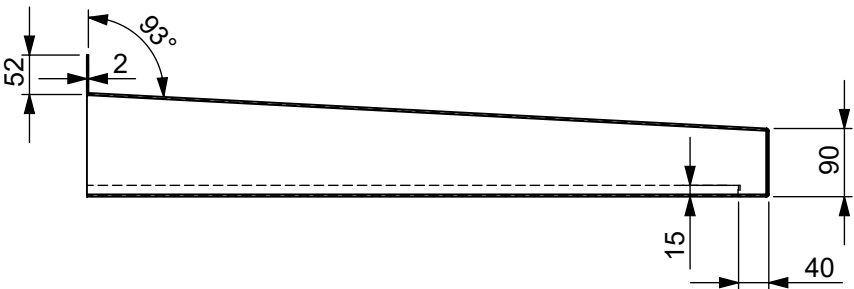
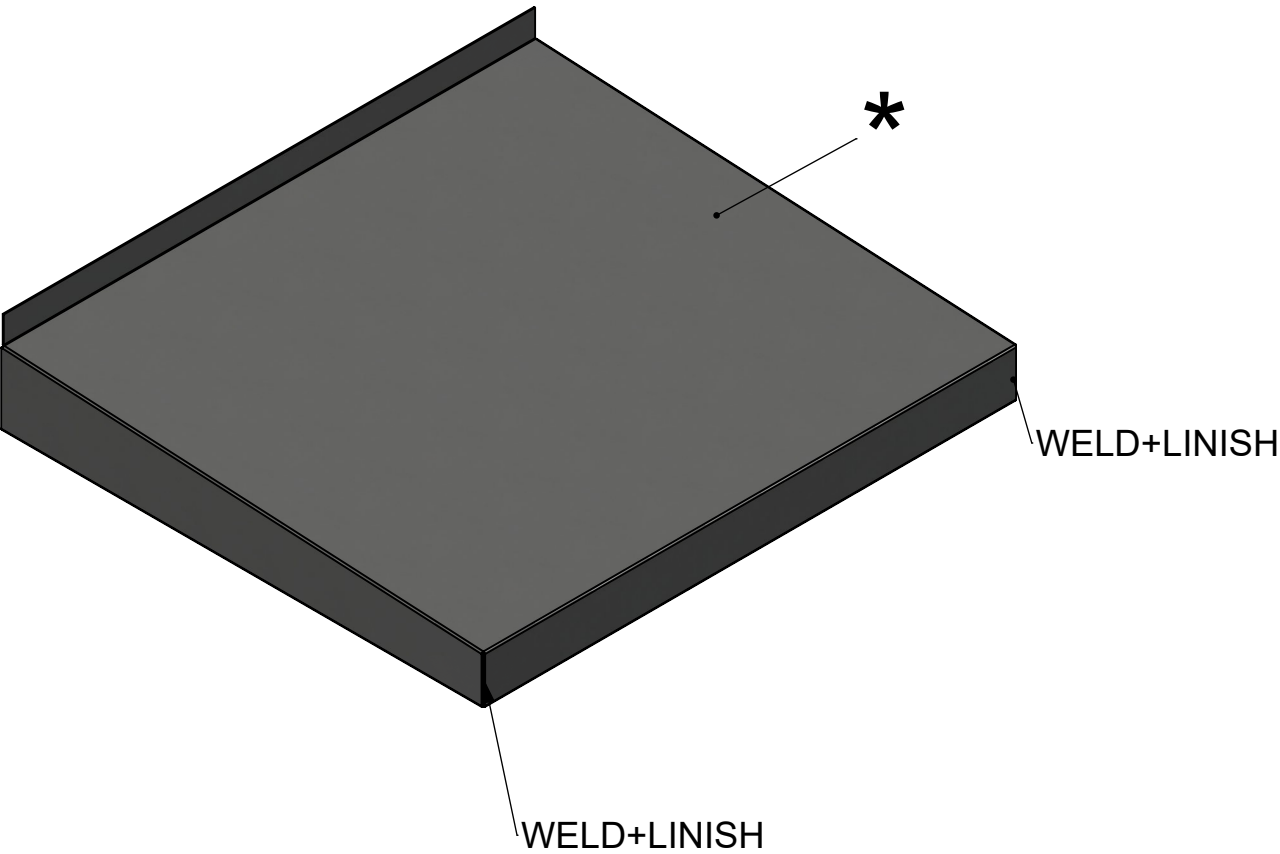
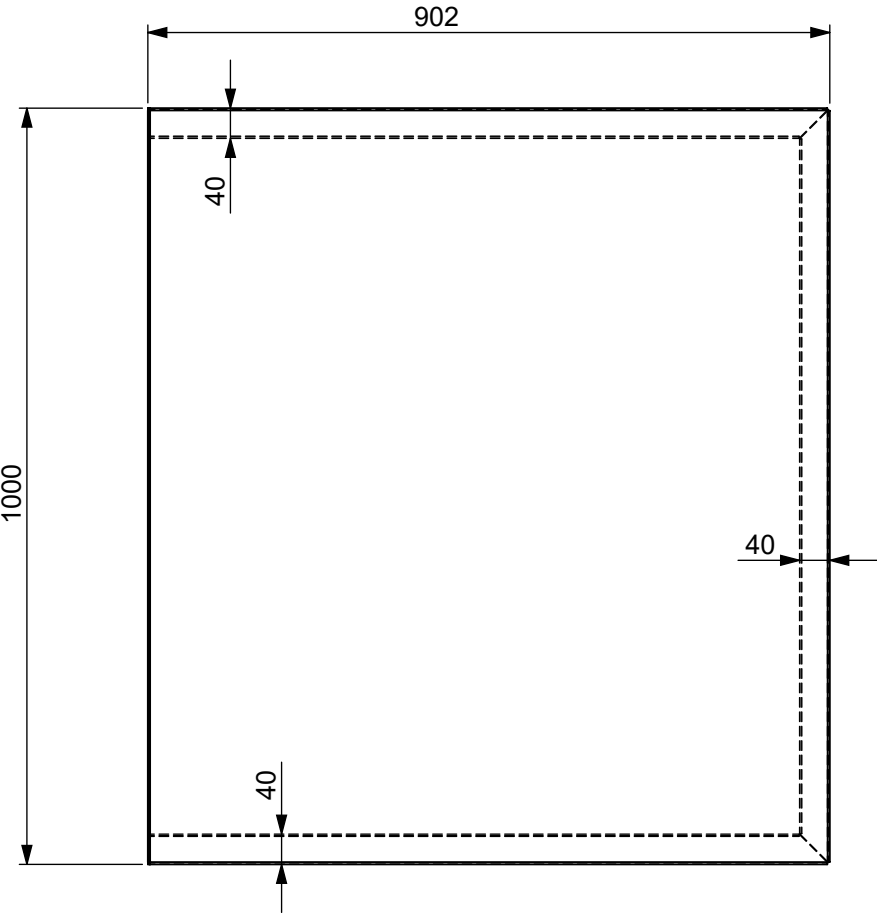

TOLERANCES	
LINEAR +/-	1mm
ANGULAR +/-	1.0°

ITEM NO.	PART/PUNCH I.D	MATERIAL GRADE	Material Thickness	QTY.
1	CA-90-1100-1M HOOD	1050A-H14	2	1
		1050A-H14		1

CUSTOMER'S APPROVAL

FULL NAME DD/MM/YYYY SIGNATURE

Designers, including but not limited to, Engineers and Architects, must satisfy themselves in respect of the adequacy of the design provided by Alumasc Water Management Solutions ("Alumasc"). It is the Designer's responsibility to ensure that the data has been correctly interpreted. Alumasc accepts no liability for inadequate or inaccurate designs based on limited or false information supplied by the Designer or misinterpretation of the data supplied. For the avoidance of doubt, designs provided by Alumasc prior to an order being placed are for illustrative purposes only and should not be relied upon save for at the Designer's own risk. Drawings issued by Alumasc in respect of an order after that order has been placed shall be fit for the purpose for which it was created.



In association with Skyline Brand

SOR NO.	-
LINE NO.	-
PROJECT:	CANOPY
CUST REF:	AWMS
SP REF NO.	SKYLINE

STAGE	DD/MM/YY	INITIALS
CUT		
PUNCH		
BRAKE		
WELD		

Copyright © 2017 all rights reserved, this drawing is the property of Alumasc Exterior Building Products.

UNLESS OTHERWISE SPECIFIED: DIMENSIONS ARE IN MILLIMETERS

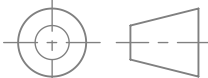

PROJECTION: THIRD ANGLE

DATE:	DESCRIPTION	REV
APPROVED: -	APRV DATE: -	
MATERIAL: SEE DRAWING	WEIGHT (KG): 17353.8	
TITLE 1: CANOPY	TITLE 2: 1M	REV. A
DRAWN: JC	DATE: 04/02/2021	
SCALE: 1:10 @ A3	SHEET: 1 OF 1	

DWG No. CA-90-1100-1M

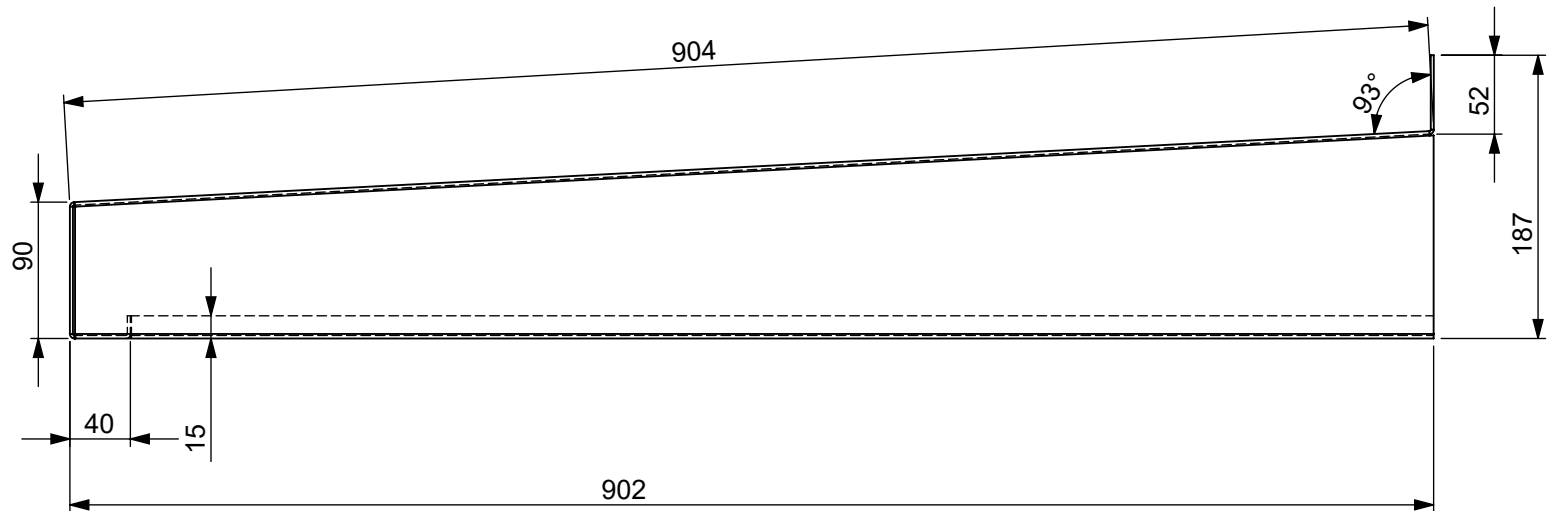
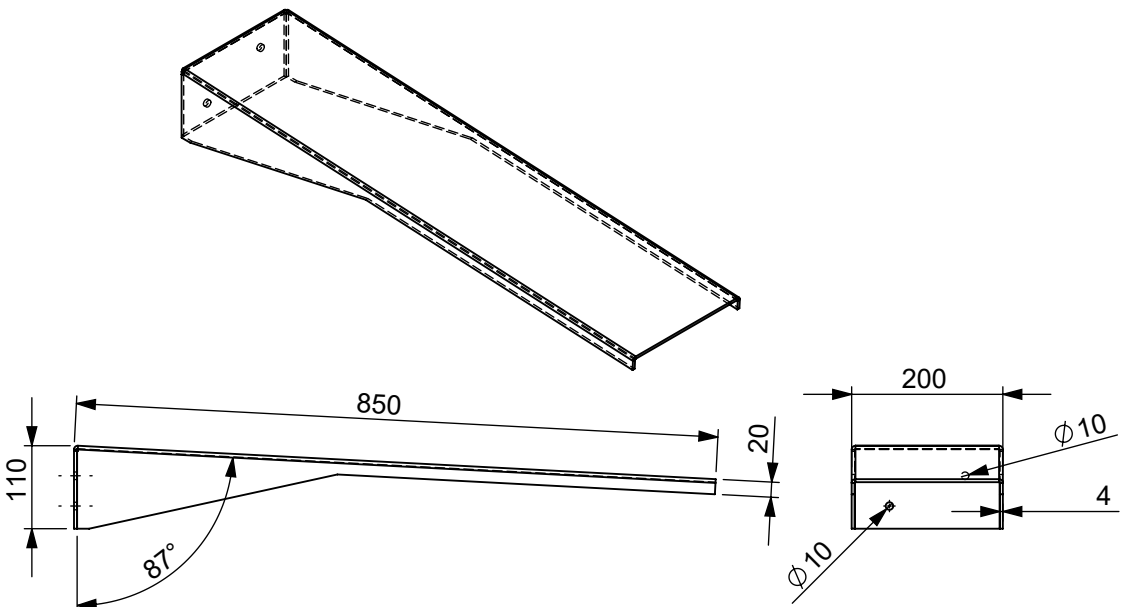

DETAIL A  
SCALE 1 : 1

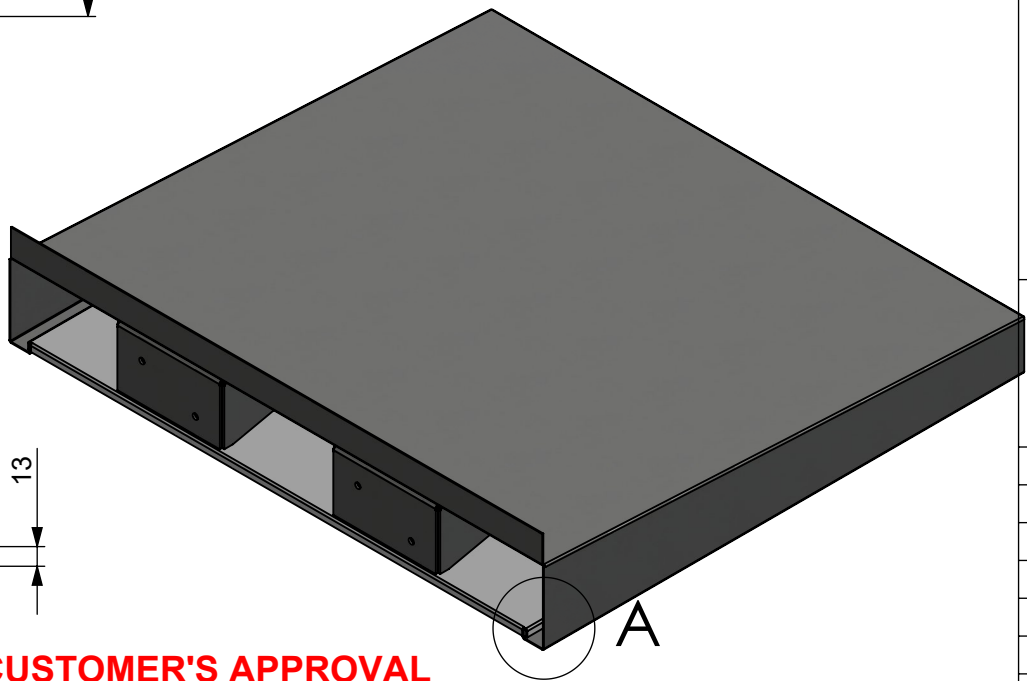
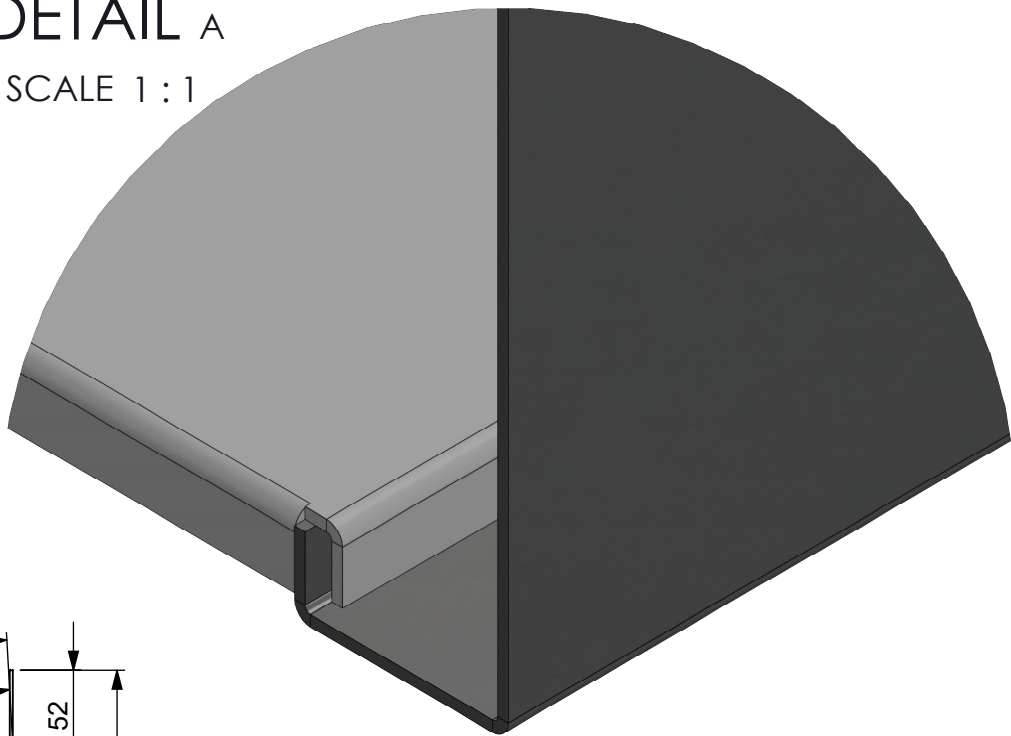

CUSTOMER'S APPROVAL

FULL NAME DD/MM/YYYY SIGNATURE

TOLERANCES	
LINEAR +/-	1mm
ANGULAR +/-	1.0°

Designers, including but not limited to, Engineers and Architects, must satisfy themselves in respect of the adequacy of the design provided by Alumasc Water Management Solutions ("Alumasc"). It is the Designer's responsibility to ensure that the data has been correctly interpreted. Alumasc accepts no liability for inadequate or inaccurate designs based on limited or false information supplied by the Designer or misinterpretation of the data supplied. For the avoidance of doubt, designs provided by Alumasc prior to an order being placed are for illustrative purposes only and should not be relied upon save for at the Designer's own risk. Drawings issued by Alumasc in respect of an order after that order has been placed shall be fit for the purpose for which it was created.



In association with Skyline Brand

SOR NO.	SOFFIT 1M
LINE NO.	CA/90/1100/1M
PROJECT:	CANOPY
CUST REF:	CA
SP REF NO.	-

STAGE	DD/MM/YY	INITIALS
CUT		
PUNCH		
BRAKE		
WELD		

FOR PART QUANTITIES, AND REQUIRED FINISH, PLEASE REFER TO WORKS ORDER SOFFIT 1M ACCOMPANYING THIS DRAWING

PARTS REQUIRING PPC FINISHES WILL REQUIRE HANGING HOLES, UNLESS SPECIFIED, HANGING HOLES WILL NOT BE POSITIONED WITHIN A 'SHOW' FACE (SHOW FACES INDICATED BY AN ASTERISK "\*\*")

PLEASE NOTE PPC PARTS MAY REQUIRE A HANGING HOLE IN A FACE TO ENABLE PRODUCT TO BE HUNG VERTICALLY THROUGH PPC PLANT

Copyright © 2017 all rights reserved, this drawing is the property of Alumasc Exterior Building Products.

UNLESS OTHERWISE SPECIFIED: DIMENSIONS ARE IN MILLIMETERS

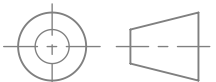

PROJECTION: THIRD ANGLE

DATE:	DESCRIPTION	REV
APPROVED: -	APRV DATE: -	
MATERIAL: 1050A-H14	WEIGHT (KG): 4574.1	
TITLE 1: CA/90/1100/1M	TITLE 2: SOFFIT	REV. A
DRAWN: JC	DATE: 04/02/2021	
SCALE: 1:10 @ A3	SHEET: 1 OF 1	

PLEASE NOTE:  
NO WELD REQUIRED  
PANEL NOTCHED TO ALLOW  
ALIGNMENT

PERSPECTIVE VIEW

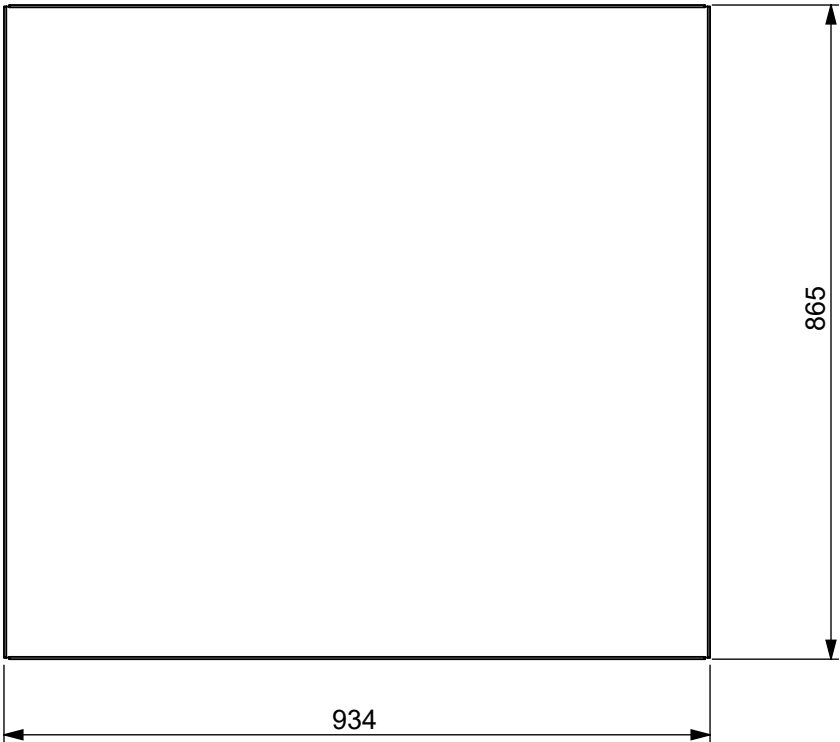
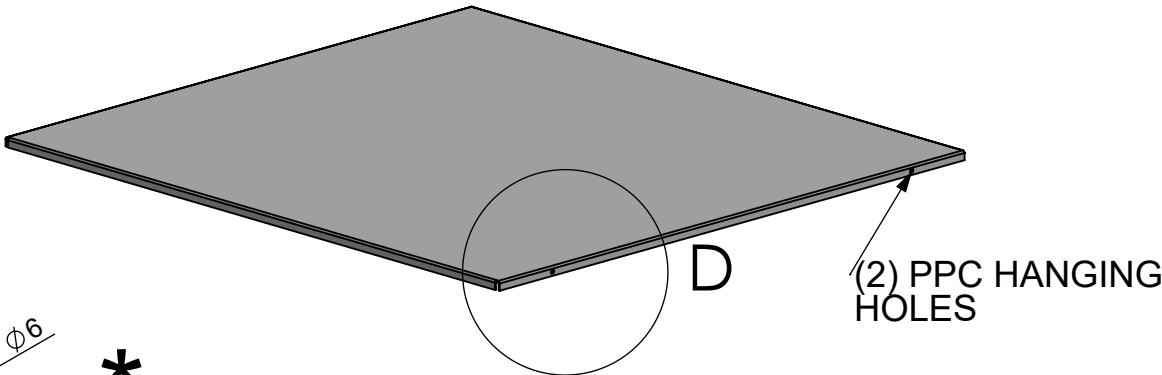

(2) PPC HANGING HOLES

D

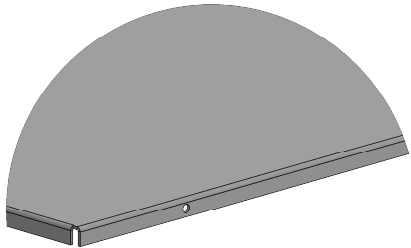

DETAIL D  
SCALE 1 : 5

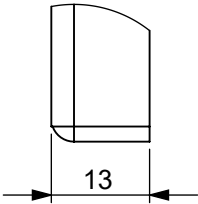

DETAIL C  
SCALE 1 : 1

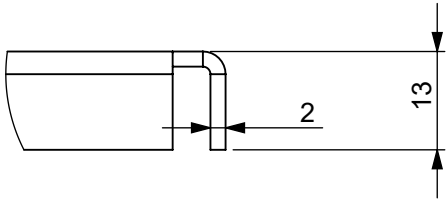

DETAIL B  
SCALE 1 : 1

TOLERANCES	
LINEAR +/-	1mm
ANGULAR +/-	1.0°

ITEM NO.	PART/PUNCH I.D	MATERIAL GRADE	Material Thickness	QTY.
1	CA-90-1100-1M SOFFIT	1050A-H14	2	1
		1050A-H14		1

CUSTOMER'S APPROVAL

FULL NAME DD/MM/YYYY SIGNATURE

Designers, including but not limited to, Engineers and Architects, must satisfy themselves in respect of the adequacy of the design provided by Alumasc Water Management Solutions ("Alumasc"). It is the Designer's responsibility to ensure that the data has been correctly interpreted. Alumasc accepts no liability for inadequate or inaccurate designs based on limited or false information supplied by the Designer or misinterpretation of the data supplied. For the avoidance of doubt, designs provided by Alumasc prior to an order being placed are for illustrative purposes only and should not be relied upon save for at the Designer's own risk. Drawings issued by Alumasc in respect of an order after that order has been placed shall be fit for the purpose for which it was created.



In association with Skyline Brand

SOR NO.	CA/90/1100/1.5M
LINE NO.	-
PROJECT:	CANOPY
CUST REF:	AWMS
SP REF NO.	SKYLINE

STAGE	DD/MM/YY	INITIALS
CUT		
PUNCH		
BRAKE		
WELD		

FOR PART QUANTITIES, AND REQUIRED FINISH, PLEASE REFER TO WORKS ORDER CA/90/1100/1.5M ACCOMPANYING THIS DRAWING

PARTS REQUIRING PPC FINISHES WILL REQUIRE HANGING HOLES, UNLESS SPECIFIED, HANGING HOLES WILL NOT BE POSITIONED WITHIN A 'SHOW' FACE (SHOW FACES INDICATED BY AN ASTERISK "\*\*")

PLEASE NOTE PPC PARTS MAY REQUIRE A HANGING HOLE IN A FACE TO ENABLE PRODUCT TO BE HUNG VERTICALLY THROUGH PPC PLANT

Copyright © 2017 all rights reserved, this drawing is the property of Alumasc Exterior Building Products.

UNLESS OTHERWISE SPECIFIED: DIMENSIONS ARE IN MILLIMETERS

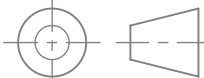

PROJECTION: THIRD ANGLE

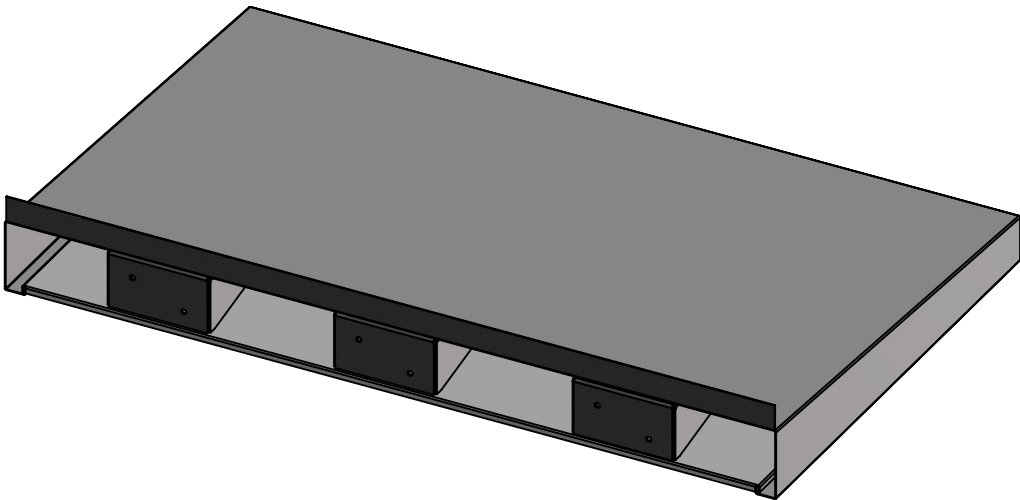
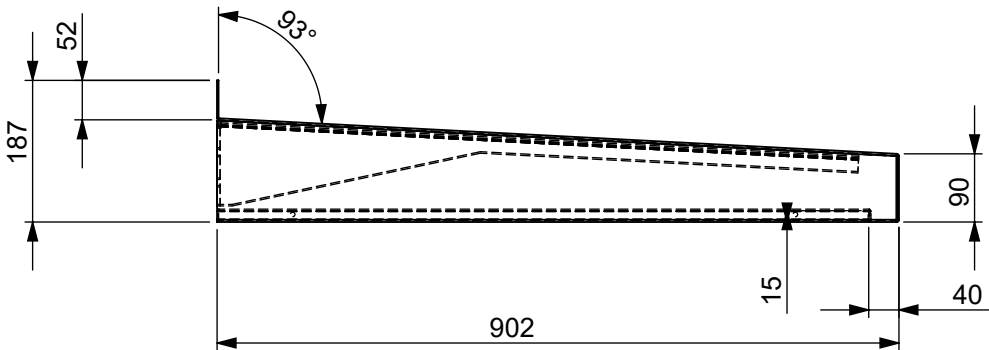
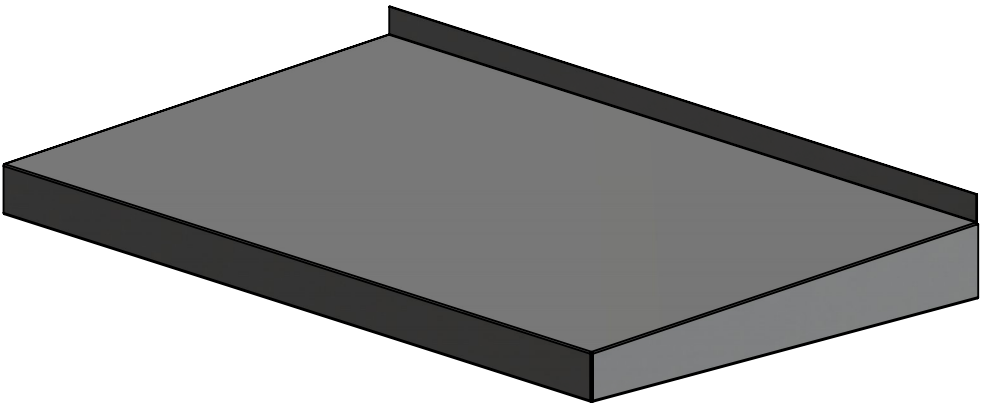
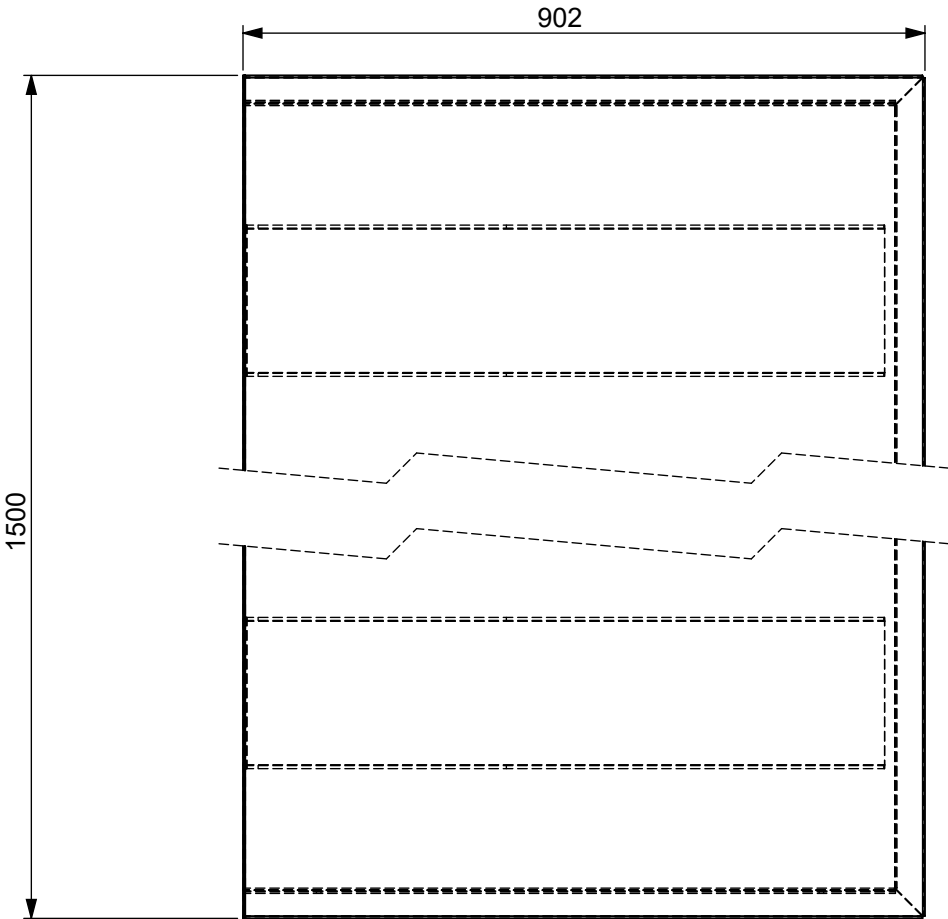

TOLERANCES	
LINEAR +/-	1mm
ANGULAR +/-	1.0°

ITEM NO.	PART/PUNCH I.D	MATERIAL GRADE	Material Thickness	QTY.
1	CA-90-1100-1.5M HOOD	1050A-H14	2	1
2	CA-90-1100-1.5M SOFFIT	1050A-H14	2	1
3	CA-90-1100-1M BRACKET	1050A-H14	4	3

CUSTOMER'S APPROVAL

FULL NAME DD/MM/YYYY SIGNATURE

Designers, including but not limited to, Engineers and Architects, must satisfy themselves in respect of the adequacy of the design provided by Alumasc Water Management Solutions ("Alumasc"). It is the Designer's responsibility to ensure that the data has been correctly interpreted. Alumasc accepts no liability for inadequate or inaccurate designs based on limited or false information supplied by the Designer or misinterpretation of the data supplied. For the avoidance of doubt, designs provided by Alumasc prior to an order being placed are for illustrative purposes only and should not be relied upon save for at the Designer's own risk. Drawings issued by Alumasc in respect of an order after that order has been placed shall be fit for the purpose for which it was created.

DATE:	DESCRIPTION	REV
APPROVED: -	APRV DATE: -	
MATERIAL: SEE DRAWING	WEIGHT (KG): 25464.8	
TITLE 1: CANOPY	TITLE 2: 1.5M	REV. A
DRAWN: JC	DATE: 04/02/2021	
SCALE: 1:10 @ A3	SHEET: 1 OF 1	



DWG No.

CA/90/1100/1.5M---A

TITLE 1

CA/90/1100/1.5M

TITLE 2

CANOPY HOOD



In association with Skyline Brand

SOR NO.	CA/90/1100/1.5M
LINE NO.	-
PROJECT:	CANOPY
CUST REF:	SKYLINE
SP REF NO.	000000

STAGE	DD/MM/YY	INITIALS
CUT		
PUNCH		
BRAKE		
WELD		

FOR PART QUANTITIES, AND REQUIRED FINISH, PLEASE REFER TO WORKS ORDER CA/90/1100/1.5M ACCOMPANYING THIS DRAWING

PARTS REQUIRING PPC FINISHES WILL REQUIRE HANGING HOLES, UNLESS SPECIFIED, HANGING HOLES WILL NOT BE POSITIONED WITHIN A 'SHOW' FACE (SHOW FACES INDICATED BY AN ASTERISK "\*\*")

PLEASE NOTE PPC PARTS MAY REQUIRE A HANGING HOLE IN A FACE TO ENABLE PRODUCT TO BE HUNG VERTICALLY THROUGH PPC PLANT

Copyright © 2017 all rights reserved, this drawing is the property of Alumasc Exterior Building Products.

UNLESS OTHERWISE SPECIFIED: DIMENSIONS ARE IN MILLIMETERS

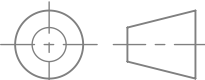

PROJECTION: THIRD ANGLE

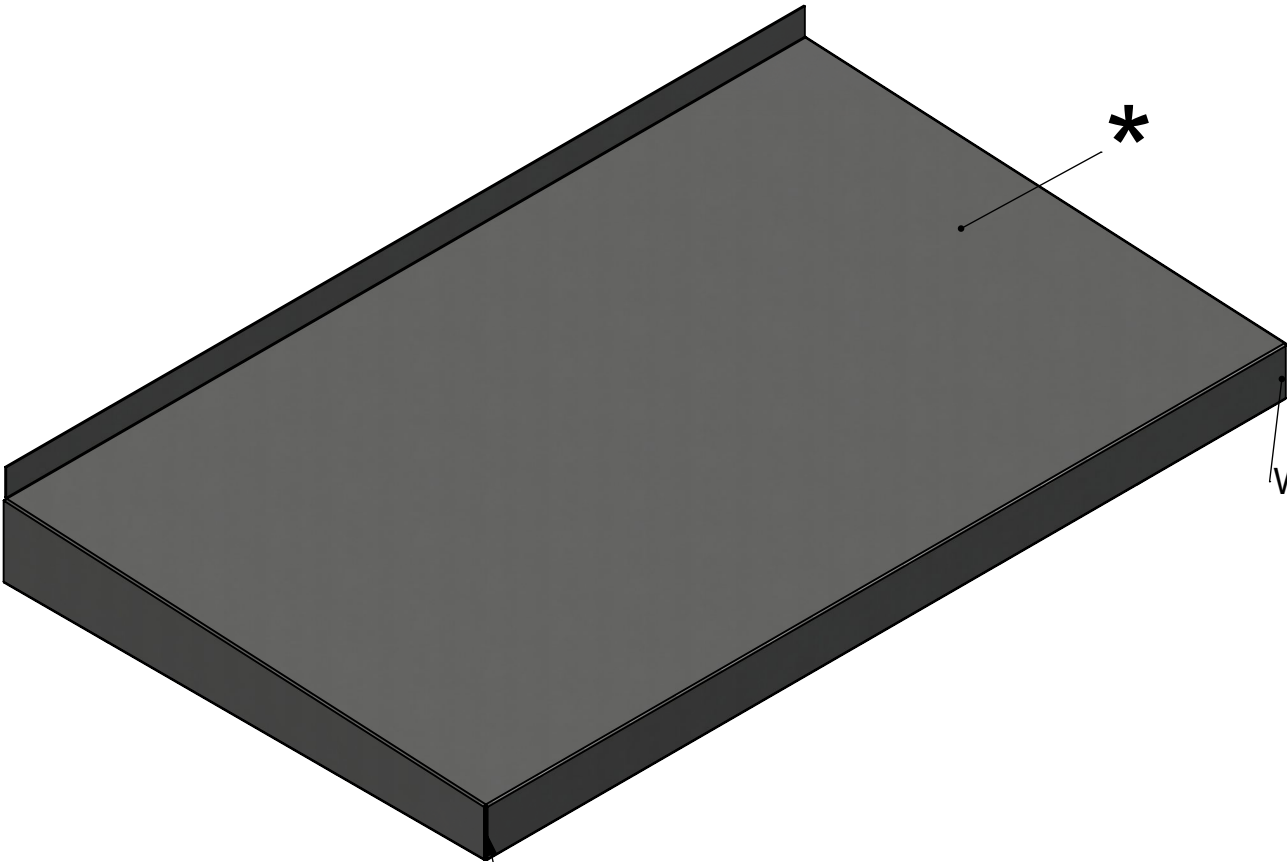
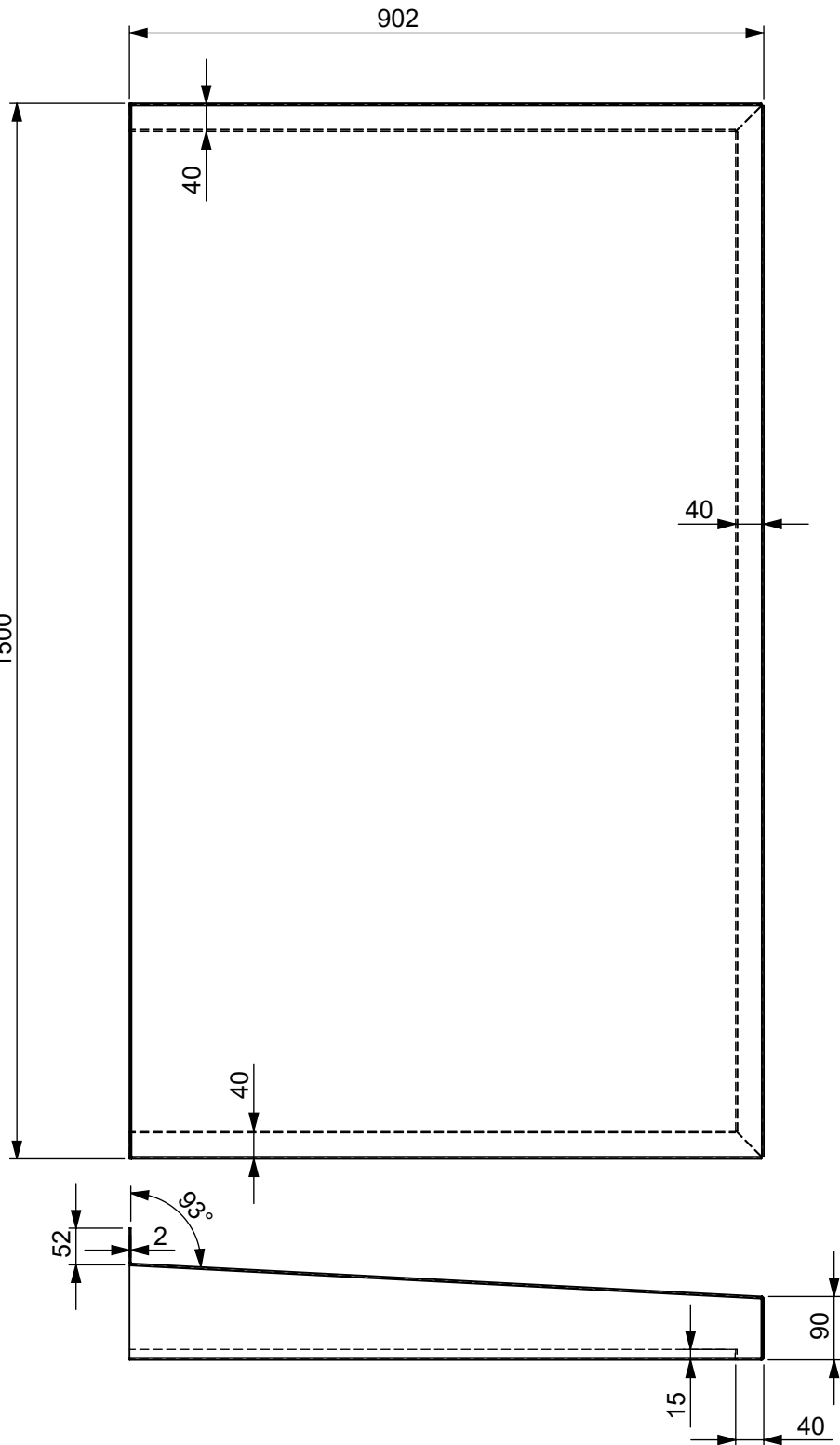

WELD+LINISH

WELD+LINISH

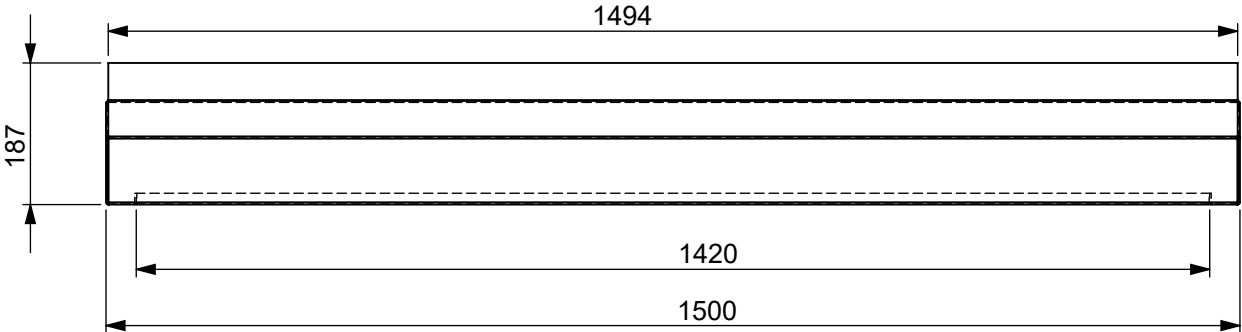

TOLERANCES	
LINEAR +/-	1mm
ANGULAR +/-	1.0°

ITEM NO.	PART/PUNCH I.D	MATERIAL GRADE	Material Thickness	QTY.
1	CA-90-1100-1.5M HOOD	1050A-H14	2	1
		1050A-H14		1

CUSTOMER'S APPROVAL

FULL NAME DD/MM/YYYY SIGNATURE

Designers, including but not limited to, Engineers and Architects, must satisfy themselves in respect of the adequacy of the design provided by Alumasc Water Management Solutions ("Alumasc"). It is the Designer's responsibility to ensure that the data has been correctly interpreted. Alumasc accepts no liability for inadequate or inaccurate designs based on limited or false information supplied by the Designer or misinterpretation of the data supplied. For the avoidance of doubt, designs provided by Alumasc prior to an order being placed are for illustrative purposes only and should not be relied upon save for at the Designer's own risk. Drawings issued by Alumasc in respect of an order after that order has been placed shall be fit for the purpose for which it was created.

DATE:	DESCRIPTION	REV
APPROVED: -	APRV DATE: -	
MATERIAL: 1050A-H14	WEIGHT (KG): 10382.9	
TITLE 1: CA/90/1100/1.5M	TITLE 2: CANOPY HOOD	REV. A
DRAWN: JC	DATE: 04/02/2021	
SCALE: 1:10 @ A3	SHEET: 1 OF 1	

DWG No.

CA/90/1100/1.5M---A

DWG No.

SOFFIT 1.5M -CA/90/1100/1.5M-A

TITLE 1

CA/90/1100/1.5M

TITLE 2

SOFFIT



In association with Skyline Brand

SOR NO.	SOFFIT 1.5M
LINE NO.	CA/90/1100/1.5M
PROJECT:	CANOPY
CUST REF:	CA
SP REF NO.	-

STAGE	DD/MM/YY	INITIALS
CUT		
PUNCH		
BRAKE		
WELD		

FOR PART QUANTITIES, AND REQUIRED FINISH, PLEASE REFER TO WORKS ORDER SOFFIT 1.5M ACCOMPANYING THIS DRAWING

PARTS REQUIRING PPC FINISHES WILL REQUIRE HANGING HOLES, UNLESS SPECIFIED, HANGING HOLES WILL NOT BE POSITIONED WITHIN A 'SHOW' FACE (SHOW FACES INDICATED BY AN ASTERISK "\*\*")

PLEASE NOTE PPC PARTS MAY REQUIRE A HANGING HOLE IN A FACE TO ENABLE PRODUCT TO BE HUNG VERTICALLY THROUGH PPC PLANT

Copyright © 2017 all rights reserved, this drawing is the property of Alumasc Exterior Building Products.

UNLESS OTHERWISE SPECIFIED: DIMENSIONS ARE IN MILLIMETERS

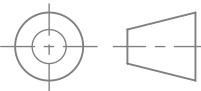

PROJECTION: THIRD ANGLE

DATE:	DESCRIPTION	REV
APPROVED: -	APRV DATE: -	
MATERIAL: 1050A-H14	WEIGHT (KG): 6973.2	
TITLE 1: CA/90/1100/1.5M	TITLE 2: SOFFIT	REV. A
DRAWN: JC	DATE: 04/02/2021	
SCALE: 1:10 @ A3	SHEET: 1 OF 1	

DWG No.

SOFFIT 1.5M -CA/90/1100/1.5M-A

PLEASE NOTE:  
NO WELD REQUIRED  
PANEL NOTCHED TO ALLOW  
ALIGNMENT

PERSPECTIVE VIEW

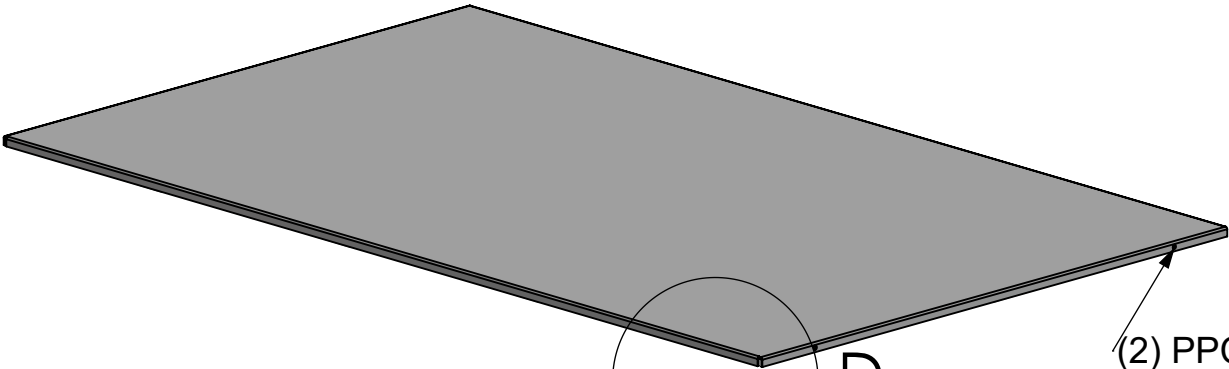

(2) PPC HANGING  
HOLES

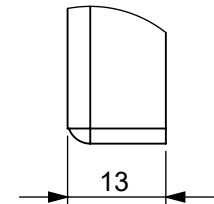
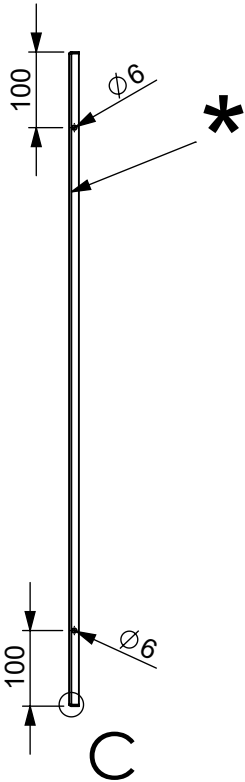
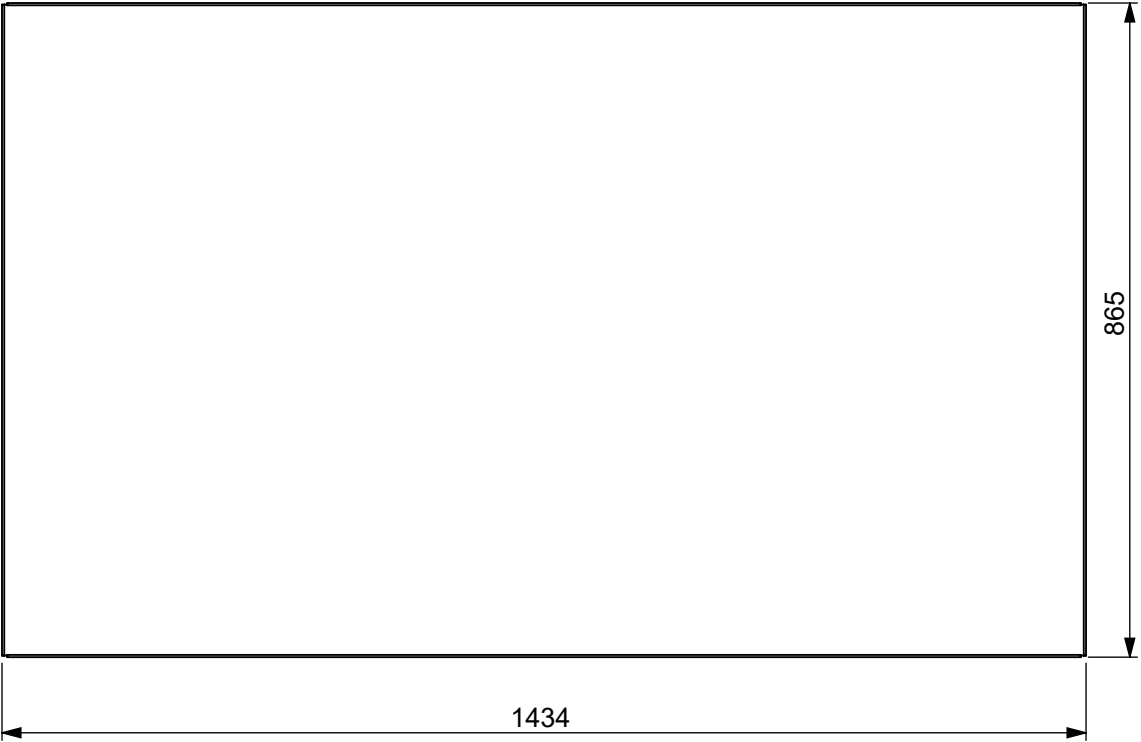

DETAIL C  
SCALE 1 : 1

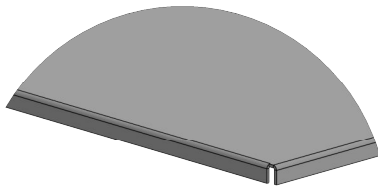

DETAIL D  
SCALE 1 : 5

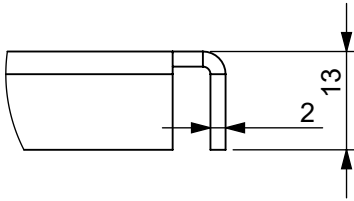

DETAIL B  
SCALE 1 : 1

TOLERANCES	
LINEAR +/-	1mm
ANGULAR +/-	1.0°

ITEM NO.	PART/PUNCH I.D	MATERIAL GRADE	Material Thickness	QTY.
1	CA-90-1100-1.5M SOFFIT	1050A-H14	2	1
		1050A-H14		1

CUSTOMER'S APPROVAL

FULL NAME DD/MM/YYYY SIGNATURE

Designers, including but not limited to, Engineers and Architects, must satisfy themselves in respect of the adequacy of the design provided by Alumasc Water Management Solutions ("Alumasc"). It is the Designer's responsibility to ensure that the data has been correctly interpreted. Alumasc accepts no liability for inadequate or inaccurate designs based on limited or false information supplied by the Designer or misinterpretation of the data supplied. For the avoidance of doubt, designs provided by Alumasc prior to an order being placed are for illustrative purposes only and should not be relied upon save for at the Designer's own risk. Drawings issued by Alumasc in respect of an order after that order has been placed shall be fit for the purpose for which it was created.



DWG No. CA/90/1100/2M---A

TITLE 1 CANOPY

TITLE 2 2M



In association with Skyline Brand

SOR NO.	CA/90/1100/2M
LINE NO.	-
PROJECT:	CANOPY
CUST REF:	AWMS
SP REF NO.	SKYLINE

STAGE	DD/MM/YY	INITIALS
CUT		
PUNCH		
BRAKE		
WELD		

FOR PART QUANTITIES, AND REQUIRED FINISH, PLEASE REFER TO WORKS ORDER CA/90/1100/2M ACCOMPANYING THIS DRAWING

PARTS REQUIRING PPC FINISHES WILL REQUIRE HANGING HOLES, UNLESS SPECIFIED, HANGING HOLES WILL NOT BE POSITIONED WITHIN A 'SHOW' FACE (SHOW FACES INDICATED BY AN ASTERISK "\*\*")

PLEASE NOTE PPC PARTS MAY REQUIRE A HANGING HOLE IN A FACE TO ENABLE PRODUCT TO BE HUNG VERTICALLY THROUGH PPC PLANT

Copyright © 2017 all rights reserved, this drawing is the property of Alumasc Exterior Building Products.

UNLESS OTHERWISE SPECIFIED: DIMENSIONS ARE IN MILLIMETERS

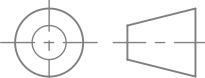

PROJECTION: THIRD ANGLE

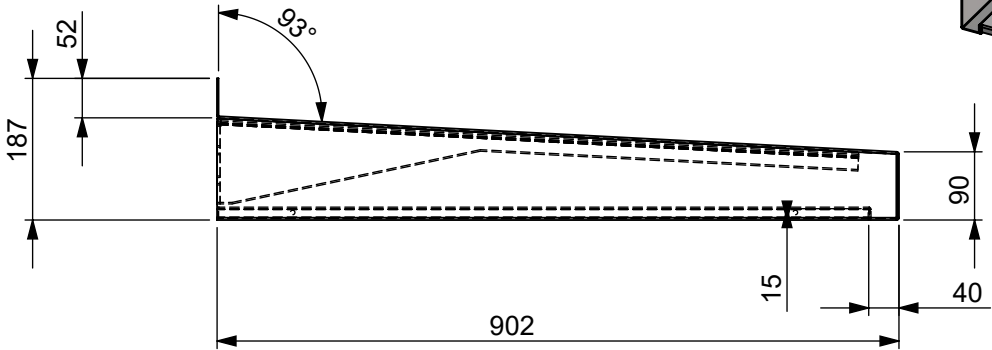
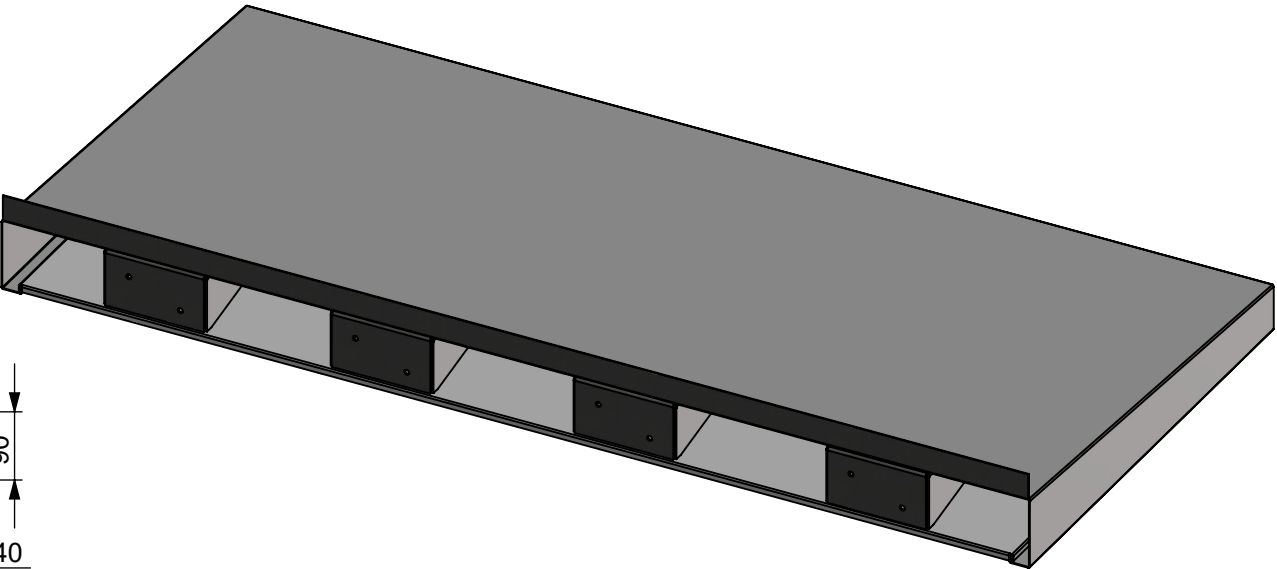
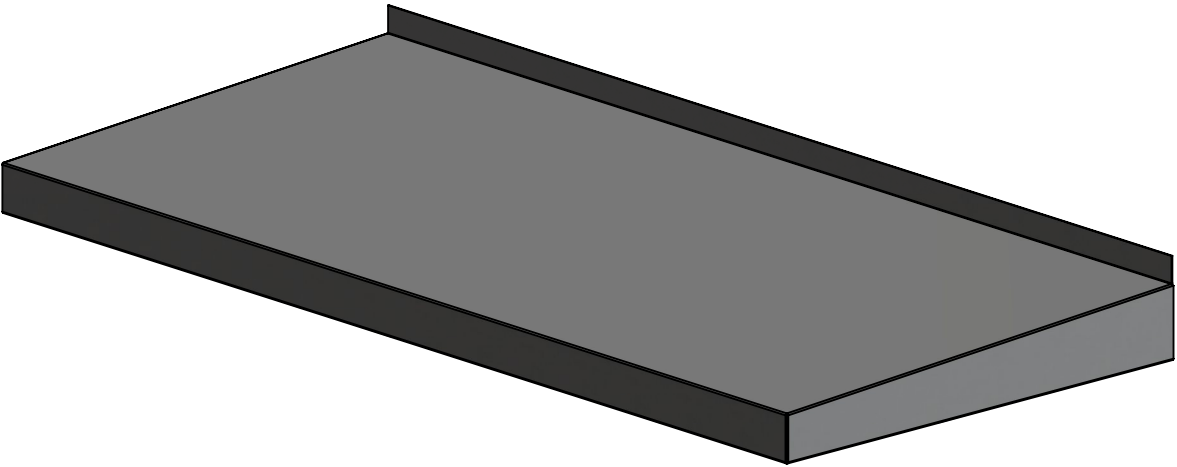
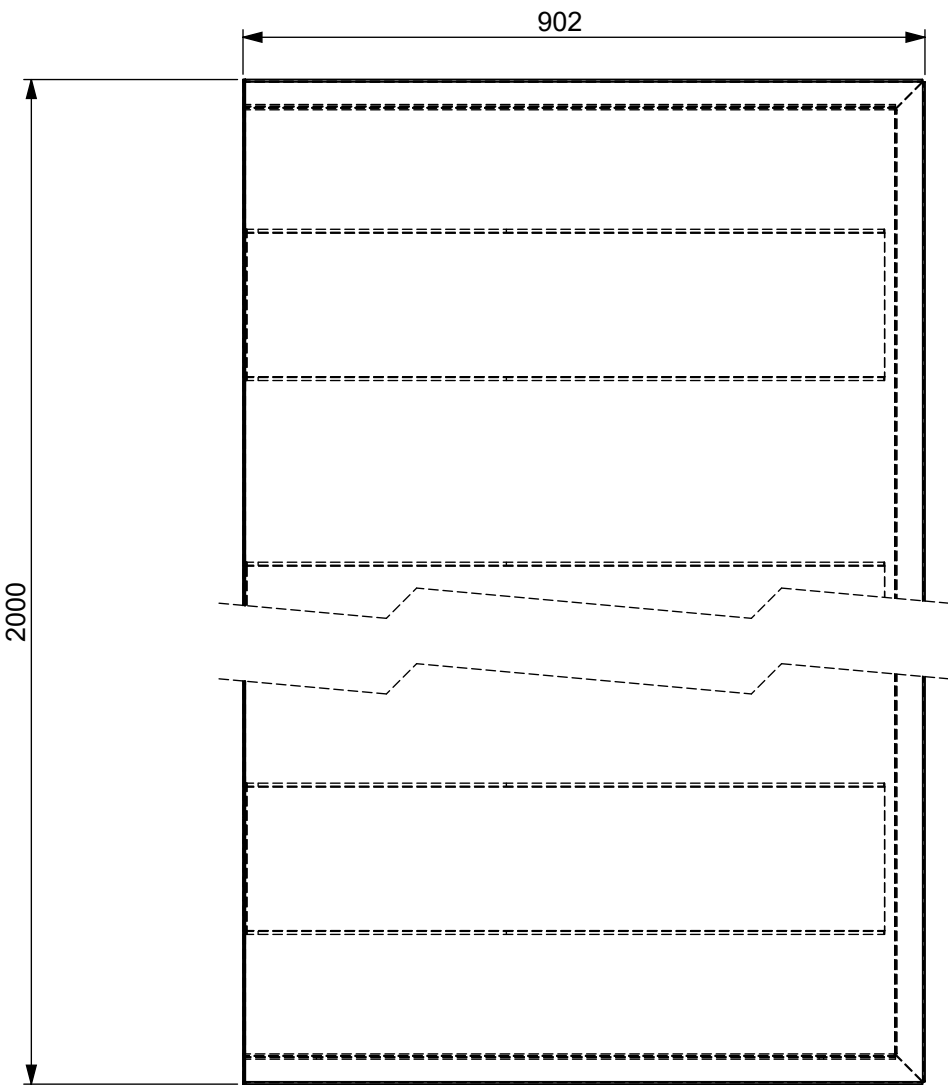

TOLERANCES	
LINEAR +/-	1mm
ANGULAR +/-	1.0°

ITEM NO.	PART/PUNCH I.D	MATERIAL GRADE	Material Thickness	QTY.
1	CA-90-1100-2M HOOD	1050A-H14	2	1
2	CA-90-1100-2M SOFFIT	1050A-H14	2	1
3	CA-90-1100-1M BRACKET	1050A-H14	4	4

CUSTOMER'S APPROVAL

FULL NAME DD/MM/YYYY SIGNATURE

Designers, including but not limited to, Engineers and Architects, must satisfy themselves in respect of the adequacy of the design provided by Alumasc Water Management Solutions ("Alumasc"). It is the Designer's responsibility to ensure that the data has been correctly interpreted. Alumasc accepts no liability for inadequate or inaccurate designs based on limited or false information supplied by the Designer or misinterpretation of the data supplied. For the avoidance of doubt, designs provided by Alumasc prior to an order being placed are for illustrative purposes only and should not be relied upon save for at the Designer's own risk. Drawings issued by Alumasc in respect of an order after that order has been placed shall be fit for the purpose for which it was created.

DWG No. CA/90/1100/2M---A

DATE:	DESCRIPTION	REV
APPROVED: -	APRV DATE: -	
MATERIAL: SEE DRAWING	WEIGHT (KG): 33518.4	
TITLE 1: CANOPY	TITLE 2: 2M	REV. A
DRAWN: JC	DATE: 04/02/2021	
SCALE: 1:10 @ A3	SHEET: 1 OF 1	

DWG No.

CA/90/1100/2M---A

TITLE 1

CA/90/1100/2M

TITLE 2

CANOPY HOOD



In association with Skyline Brand

SOR NO.	CA/90/1100/2M
LINE NO.	-
PROJECT:	CANOPY
CUST REF:	SKYLINE
SP REF NO.	000000

STAGE	DD/MM/YY	INITIALS
CUT		
PUNCH		
BRAKE		
WELD		

FOR PART QUANTITIES, AND REQUIRED FINISH, PLEASE REFER TO WORKS ORDER CA/90/1100/2M ACCOMPANYING THIS DRAWING

PARTS REQUIRING PPC FINISHES WILL REQUIRE HANGING HOLES, UNLESS SPECIFIED, HANGING HOLES WILL NOT BE POSITIONED WITHIN A 'SHOW' FACE (SHOW FACES INDICATED BY AN ASTERISK "\*\*")

PLEASE NOTE PPC PARTS MAY REQUIRE A HANGING HOLE IN A FACE TO ENABLE PRODUCT TO BE HUNG VERTICALLY THROUGH PPC PLANT

Copyright © 2017 all rights reserved, this drawing is the property of Alumasc Exterior Building Products.

UNLESS OTHERWISE SPECIFIED: DIMENSIONS ARE IN MILLIMETERS

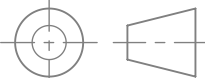

PROJECTION: THIRD ANGLE

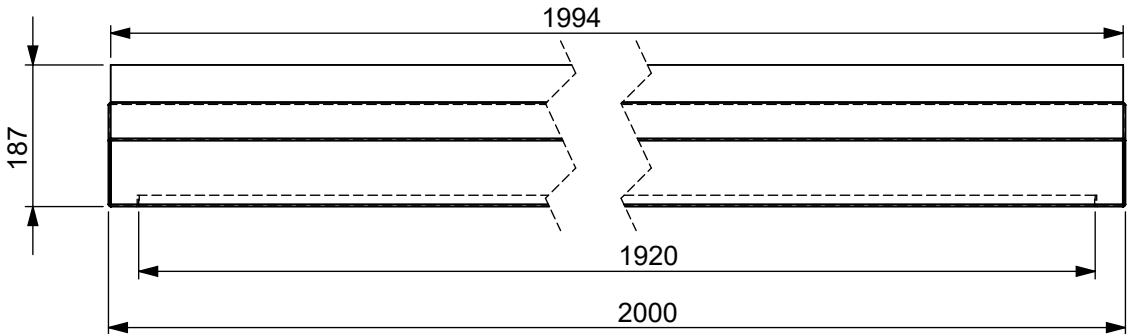
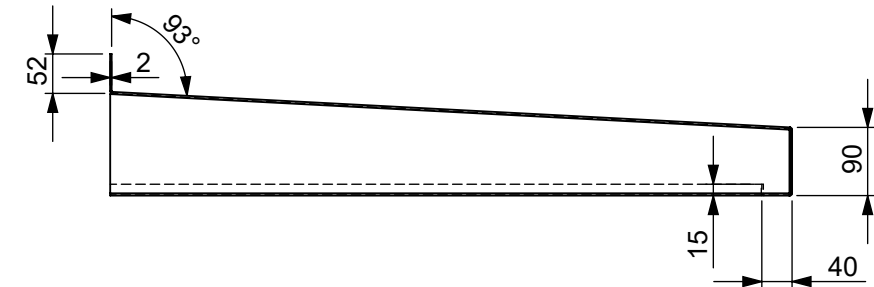
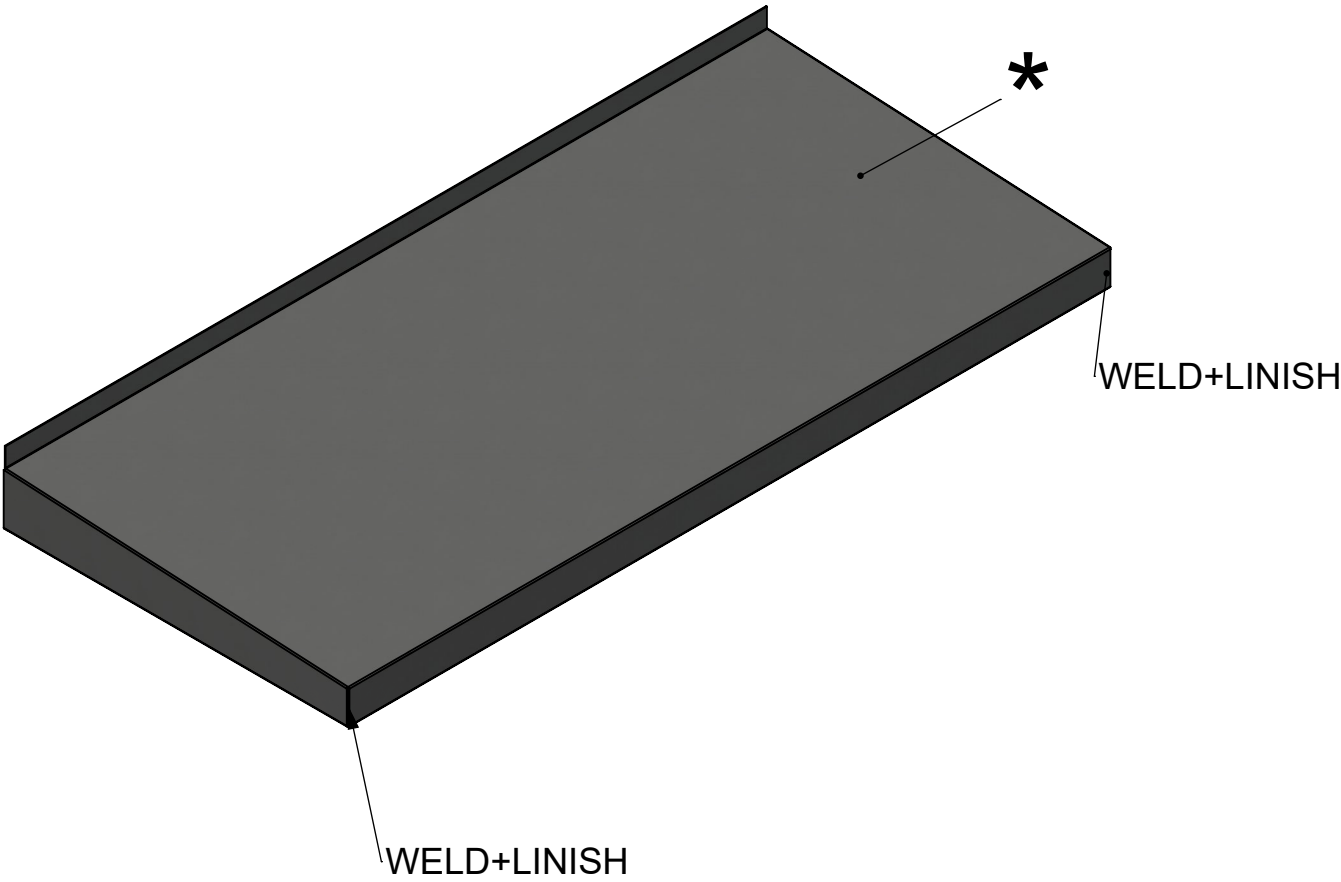
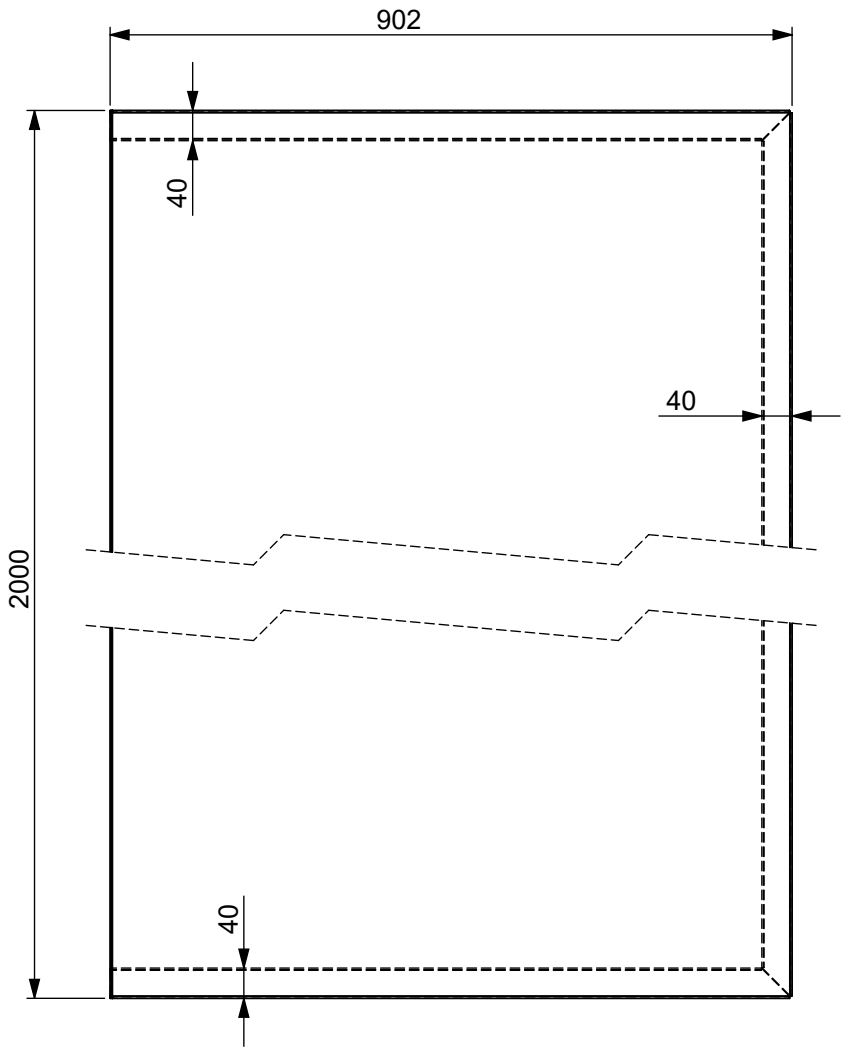

TOLERANCES	
LINEAR +/-	1mm
ANGULAR +/-	1.0°

ITEM NO.	PART/PUNCH I.D	MATERIAL GRADE	Material Thickness	QTY.
1	CA-90-1100-2M HOOD	1050A-H14	2	1
		1050A-H14		1

CUSTOMER'S APPROVAL

FULL NAME DD/MM/YYYY SIGNATURE

Designers, including but not limited to, Engineers and Architects, must satisfy themselves in respect of the adequacy of the design provided by Alumasc Water Management Solutions ("Alumasc"). It is the Designer's responsibility to ensure that the data has been correctly interpreted. Alumasc accepts no liability for inadequate or inaccurate designs based on limited or false information supplied by the Designer or misinterpretation of the data supplied. For the avoidance of doubt, designs provided by Alumasc prior to an order being placed are for illustrative purposes only and should not be relied upon save for at the Designer's own risk. Drawings issued by Alumasc in respect of an order after that order has been placed shall be fit for the purpose for which it was created.

DWG No.

CA/90/1100/2M---A

DATE:	DESCRIPTION	REV
APPROVED: -	APRV DATE: -	
MATERIAL: 1050A-H14	WEIGHT (KG): 13334.4	
TITLE 1: CA/90/1100/2M	TITLE 2: CANOPY HOOD	REV. A
DRAWN: JC	DATE: 04/02/2021	
SCALE: 1:10 @ A3	SHEET: 1 OF 1	



In association with Skyline Brand

SOR NO.	SOFFIT 2M
LINE NO.	CA/90/1100/2M
PROJECT:	CANOPY
CUST REF:	CA
SP REF NO.	-

STAGE	DD/MM/YY	INITIALS
CUT		
PUNCH		
BRAKE		
WELD		

FOR PART QUANTITIES, AND REQUIRED FINISH, PLEASE REFER TO WORKS ORDER SOFFIT 2M ACCOMPANYING THIS DRAWING

PARTS REQUIRING PPC FINISHES WILL REQUIRE HANGING HOLES, UNLESS SPECIFIED, HANGING HOLES WILL NOT BE POSITIONED WITHIN A 'SHOW' FACE (SHOW FACES INDICATED BY AN ASTERISK "\*\*")

PLEASE NOTE PPC PARTS MAY REQUIRE A HANGING HOLE IN A FACE TO ENABLE PRODUCT TO BE HUNG VERTICALLY THROUGH PPC PLANT

Copyright © 2017 all rights reserved, this drawing is the property of Alumasc Exterior Building Products.

UNLESS OTHERWISE SPECIFIED: DIMENSIONS ARE IN MILLIMETERS

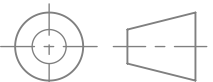

PROJECTION: THIRD ANGLE

DATE:	DESCRIPTION	REV
APPROVED: -	APRV DATE: -	
MATERIAL: 1050A-H14	WEIGHT (KG): 9372.3	
TITLE 1: CA/90/1100/2M	TITLE 2: SOFFIT	REV. A
DRAWN: JC	DATE: 04/02/2021	
SCALE: 1:10 @ A3	SHEET: 1 OF 1	

PLEASE NOTE:  
NO WELD REQUIRED  
PANEL NOTCHED TO ALLOW  
ALIGNMENT

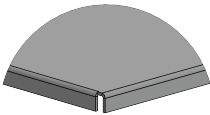
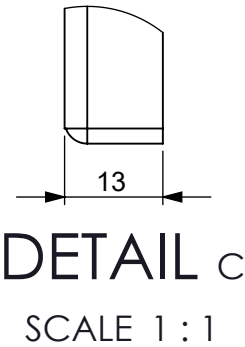
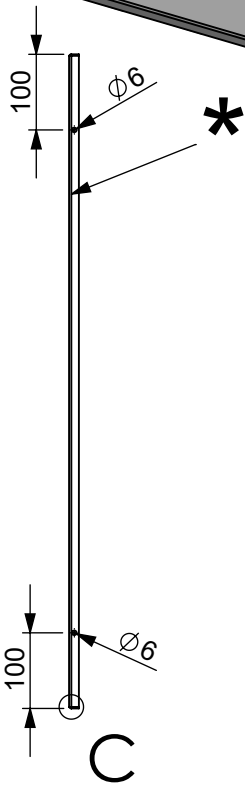
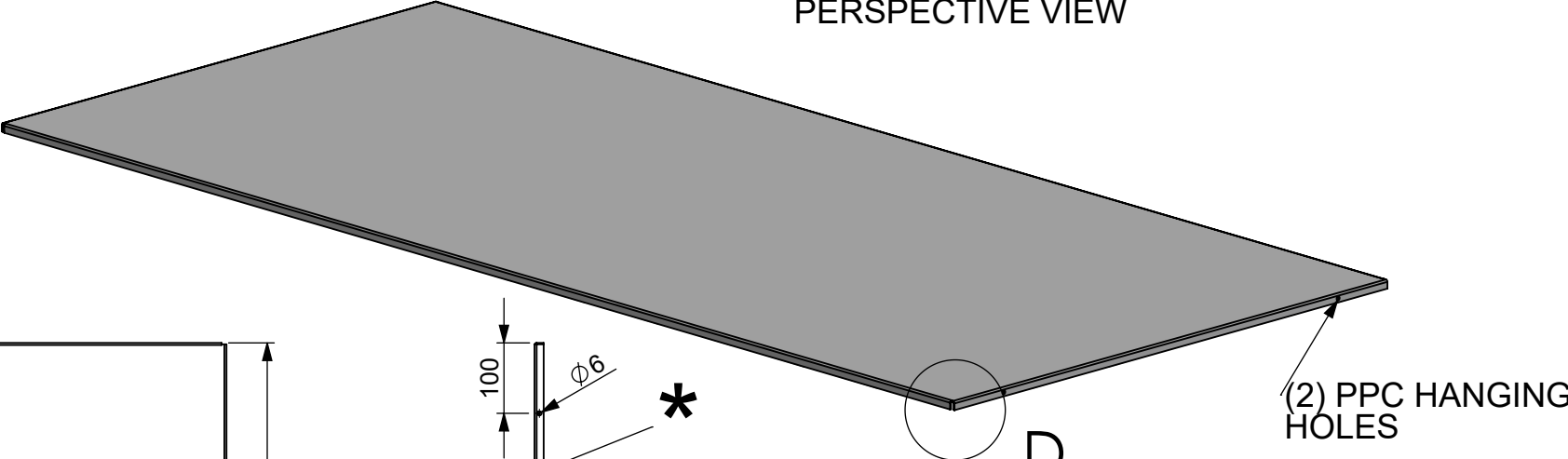
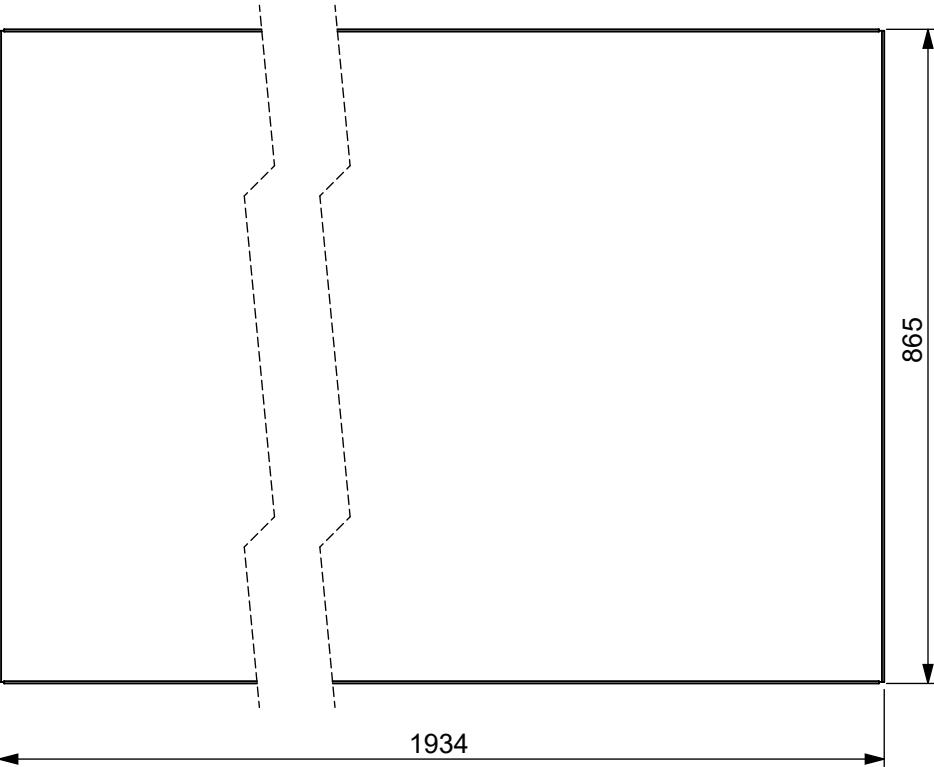

DETAIL D  
SCALE 1 : 5

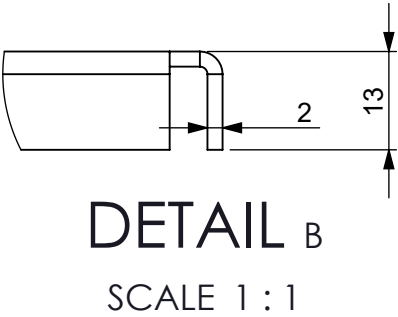

DETAIL B  
SCALE 1 : 1

TOLERANCES	
LINEAR +/-	1mm
ANGULAR +/-	1.0°

ITEM NO.	PART/PUNCH I.D	MATERIAL GRADE	Material Thickness	QTY.
1	CA-90-1100-2M SOFFIT	1050A-H14	2	1
		1050A-H14		1

CUSTOMER'S APPROVAL

FULL NAME DD/MM/YYYY SIGNATURE

Designers, including but not limited to, Engineers and Architects, must satisfy themselves in respect of the adequacy of the design provided by Alumasc Water Management Solutions ("Alumasc"). It is the Designer's responsibility to ensure that the data has been correctly interpreted. Alumasc accepts no liability for inadequate or inaccurate designs based on limited or false information supplied by the Designer or misinterpretation of the data supplied. For the avoidance of doubt, designs provided by Alumasc prior to an order being placed are for illustrative purposes only and should not be relied upon save for at the Designer's own risk. Drawings issued by Alumasc in respect of an order after that order has been placed shall be fit for the purpose for which it was created.

DWG No. CA/90/1100/2.5M---A

TITLE 1 CANOPY

TITLE 2 2.5M



In association with Skyline Brand

SOR NO.	CA/90/1100/2.5M
LINE NO.	-
PROJECT:	CANOPY
CUST REF:	AWMS
SP REF NO.	SKYLINE

STAGE	DD/MM/YY	INITIALS
CUT		
PUNCH		
BRAKE		
WELD		

FOR PART QUANTITIES, AND REQUIRED FINISH, PLEASE REFER TO WORKS ORDER CA/90/1100/2.5M ACCOMPANYING THIS DRAWING

PARTS REQUIRING PPC FINISHES WILL REQUIRE HANGING HOLES, UNLESS SPECIFIED, HANGING HOLES WILL NOT BE POSITIONED WITHIN A 'SHOW' FACE (SHOW FACES INDICATED BY AN ASTERISK "\*\*")

PLEASE NOTE PPC PARTS MAY REQUIRE A HANGING HOLE IN A FACE TO ENABLE PRODUCT TO BE HUNG VERTICALLY THROUGH PPC PLANT

Copyright © 2017 all rights reserved, this drawing is the property of Alumasc Exterior Building Products.

UNLESS OTHERWISE SPECIFIED: DIMENSIONS ARE IN MILLIMETERS

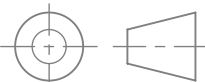

PROJECTION: THIRD ANGLE

DATE:	DESCRIPTION	REV
APPROVED: -	APRV DATE: -	
MATERIAL: SEE DRAWING	WEIGHT (KG): 38869.1	
TITLE 1: CANOPY	TITLE 2: 2.5M	REV. A
DRAWN: JC	DATE: 04/02/2021	
SCALE: 1:10 @ A3	SHEET: 1 OF 1	

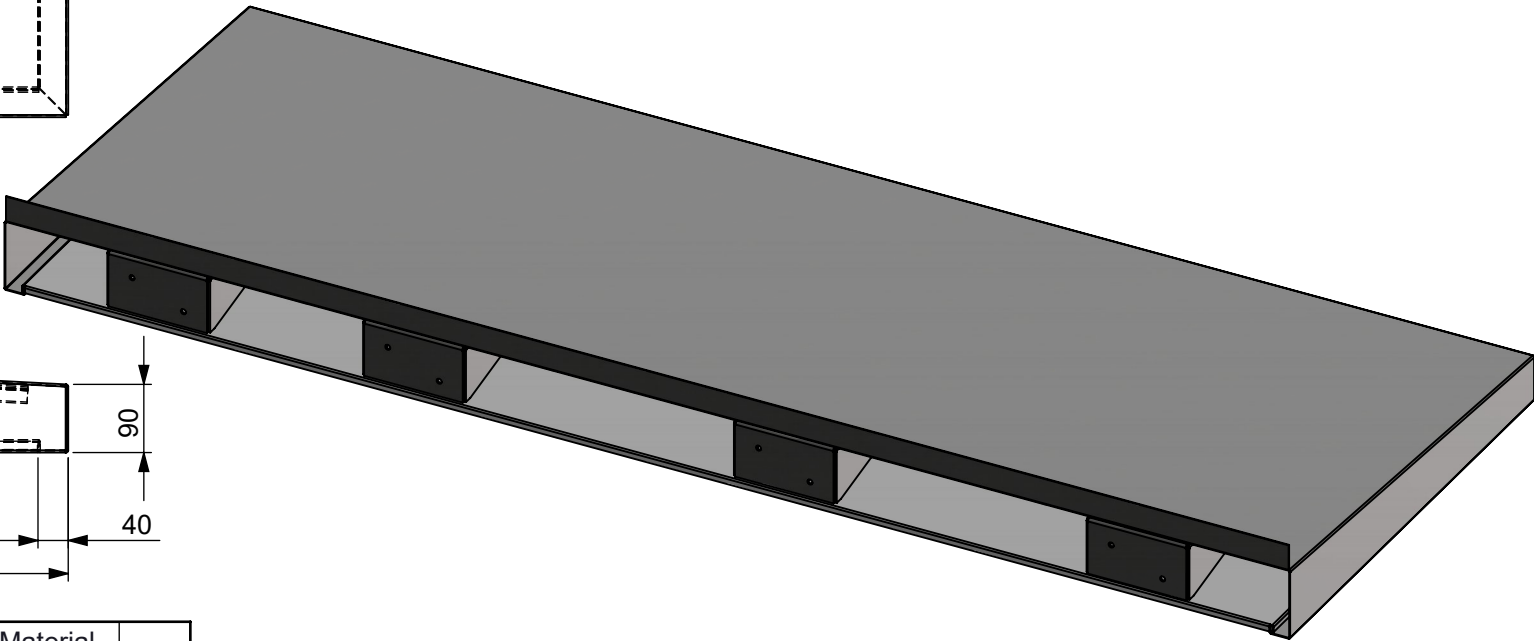
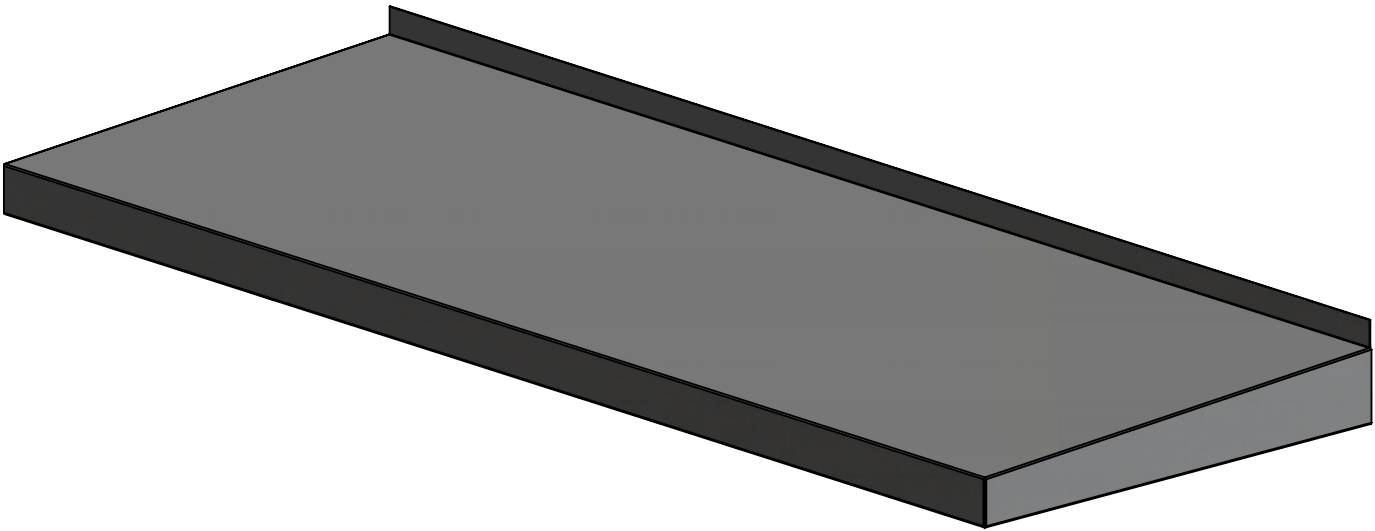
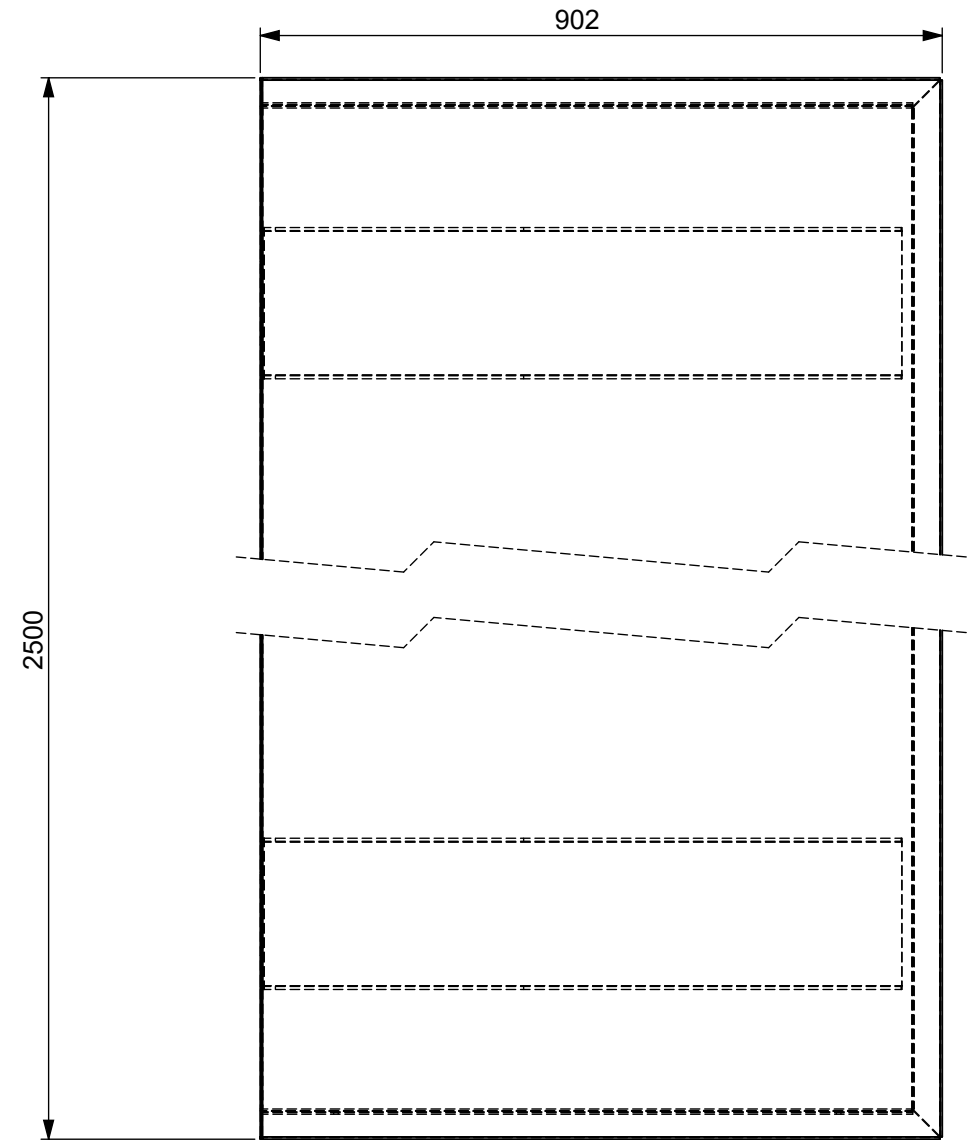

CUSTOMER'S APPROVAL

FULL NAME DD/MM/YYYY SIGNATURE

TOLERANCES	
LINEAR +/-	1mm
ANGULAR +/-	1.0°

ITEM NO.	PART/PUNCH I.D	MATERIAL GRADE	Material Thickness	QTY.
1	CA-90-1100-2.5M HOOD	1050A-H14	2	1
2	CA-90-1100-2.5M SOFFIT	1050A-H14	2	1
3	CA-90-1100-1M BRACKET	1050A-H14	4	4

Designers, including but not limited to, Engineers and Architects, must satisfy themselves in respect of the adequacy of the design provided by Alumasc Water Management Solutions ("Alumasc"). It is the Designer's responsibility to ensure that the data has been correctly interpreted. Alumasc accepts no liability for inadequate or inaccurate designs based on limited or false information supplied by the Designer or misinterpretation of the data supplied. For the avoidance of doubt, designs provided by Alumasc prior to an order being placed are for illustrative purposes only and should not be relied upon save for at the Designer's own risk. Drawings issued by Alumasc in respect of an order after that order has been placed shall be fit for the purpose for which it was created.

DWG No. CA/90/1100/2.5M---A

DWG No.

CA/90/1100/2.5M---A

TITLE 1

CA/90/1100/2.5M

TITLE 2

CANOPY HOOD



In association with Skyline Brand

SOR NO.	CA/90/1100/2.5M
LINE NO.	-
PROJECT:	CANOPY
CUST REF:	SKYLINE
SP REF NO.	-

STAGE	DD/MM/YY	INITIALS
CUT		
PUNCH		
BRAKE		
WELD		

FOR PART QUANTITIES, AND REQUIRED FINISH, PLEASE REFER TO WORKS ORDER CA/90/1100/2.5M ACCOMPANYING THIS DRAWING

PARTS REQUIRING PPC FINISHES WILL REQUIRE HANGING HOLES, UNLESS SPECIFIED, HANGING HOLES WILL NOT BE POSITIONED WITHIN A 'SHOW' FACE (SHOW FACES INDICATED BY AN ASTERISK "\*\*")

PLEASE NOTE PPC PARTS MAY REQUIRE A HANGING HOLE IN A FACE TO ENABLE PRODUCT TO BE HUNG VERTICALLY THROUGH PPC PLANT

Copyright © 2017 all rights reserved, this drawing is the property of Alumasc Exterior Building Products.

UNLESS OTHERWISE SPECIFIED: DIMENSIONS ARE IN MILLIMETERS

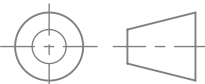

PROJECTION: THIRD ANGLE

DATE:	DESCRIPTION	REV
APPROVED: -	APRV DATE: -	
MATERIAL: 1050A-H14	WEIGHT (KG): 16286.0	
TITLE 1: CA/90/1100/2.5M		REV. A
TITLE 2: CANOPY HOOD		
DRAWN: JC	DATE: 04/02/2021	
SCALE: 1:10 @ A3	SHEET: 1 OF 1	

DWG No.

CA/90/1100/2.5M---A

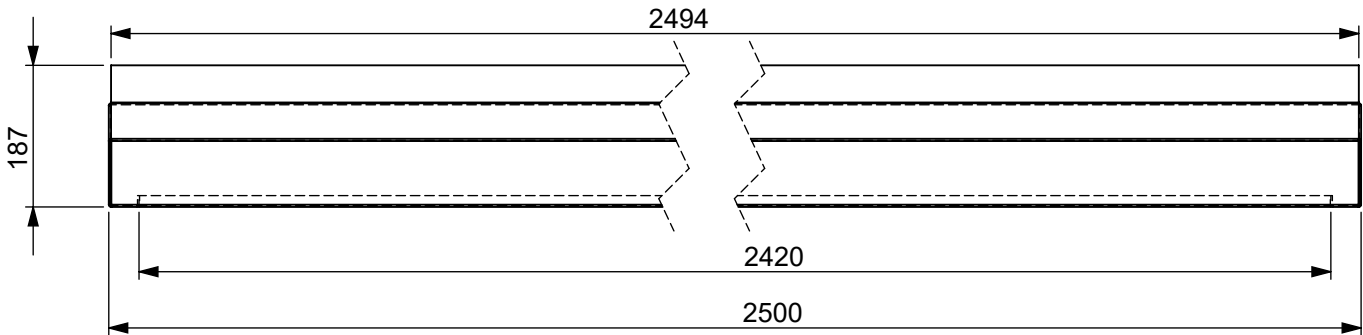
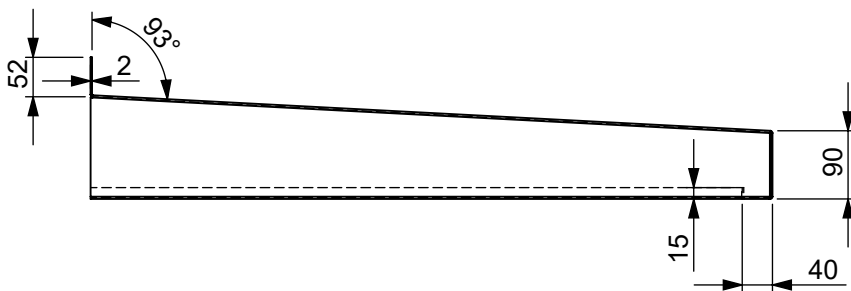
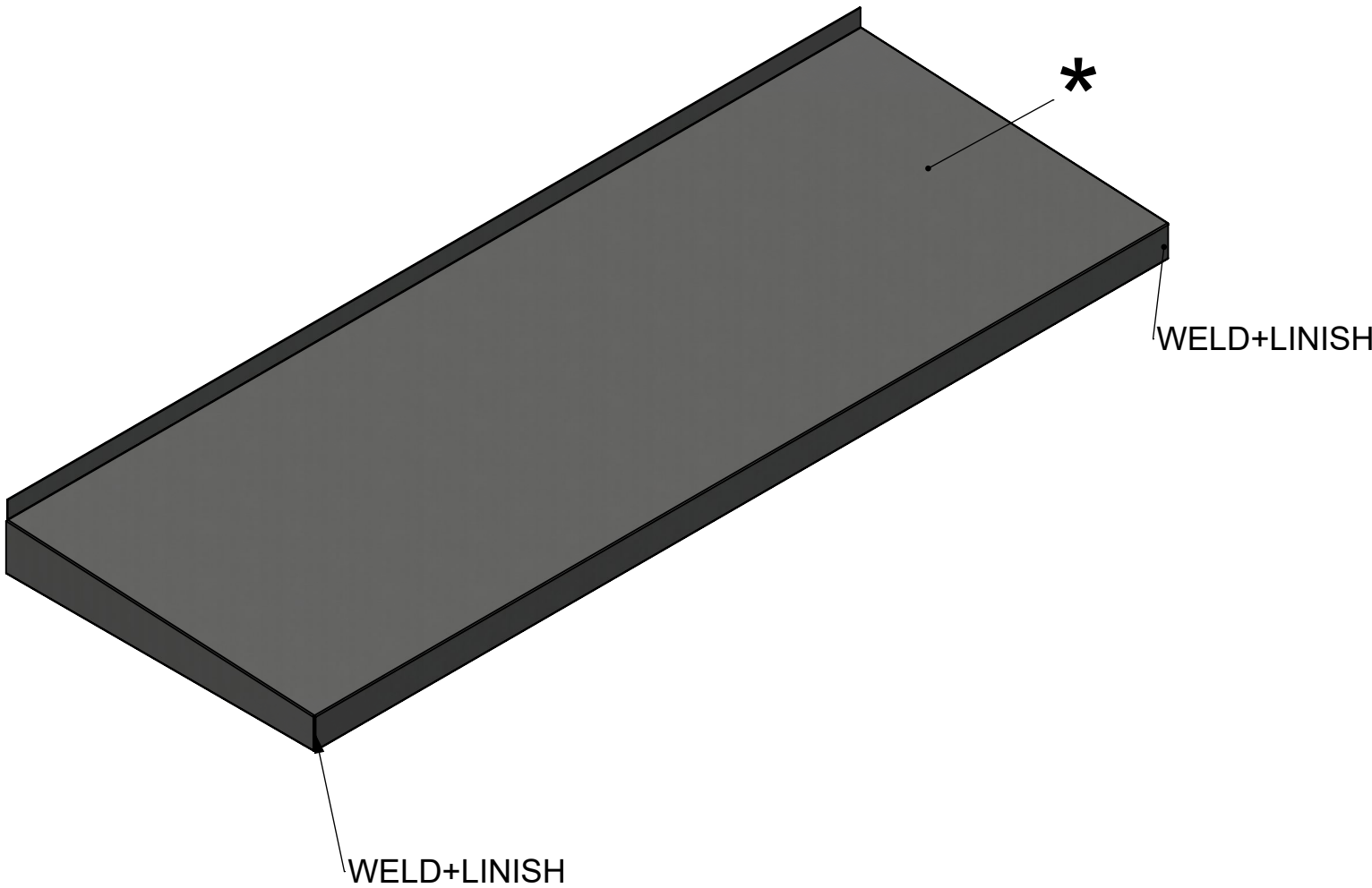
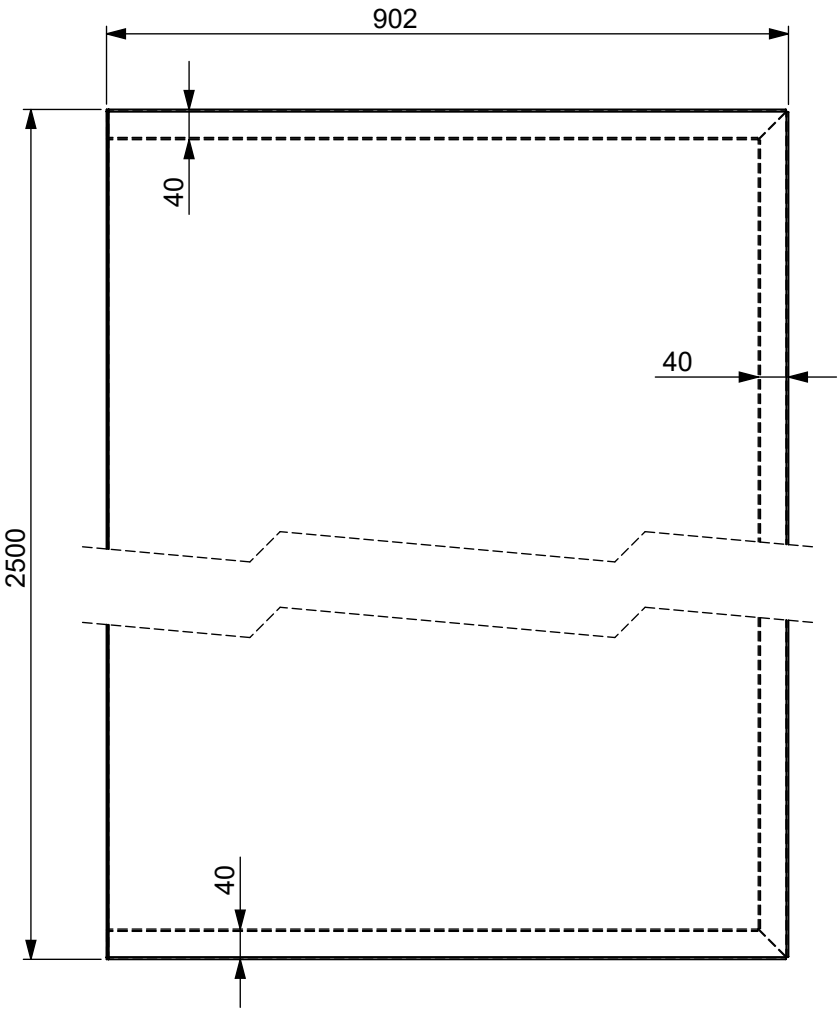

TOLERANCES	
LINEAR +/-	1mm
ANGULAR +/-	1.0°

ITEM NO.	PART/PUNCH I.D	MATERIAL GRADE	Material Thickness	QTY.
1	CA-90-1100-2.5M HOOD	1050A-H14	2	1
		1050A-H14		1

CUSTOMER'S APPROVAL

FULL NAME DD/MM/YYYY SIGNATURE

Designers, including but not limited to, Engineers and Architects, must satisfy themselves in respect of the adequacy of the design provided by Alumasc Water Management Solutions ("Alumasc"). It is the Designer's responsibility to ensure that the data has been correctly interpreted. Alumasc accepts no liability for inadequate or inaccurate designs based on limited or false information supplied by the Designer or misinterpretation of the data supplied. For the avoidance of doubt, designs provided by Alumasc prior to an order being placed are for illustrative purposes only and should not be relied upon save for at the Designer's own risk. Drawings issued by Alumasc in respect of an order after that order has been placed shall be fit for the purpose for which it was created.

DWG No.

SOFFIT 2.5M -CA/90/1100/2.5M-A

TITLE 1

CA/90/1100/2.5M

TITLE 2

SOFFIT

PLEASE NOTE:  
NO WELD REQUIRED  
PANEL NOTCHED TO ALLOW  
ALIGNMENT

PERSPECTIVE VIEW

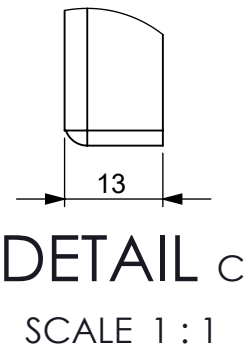
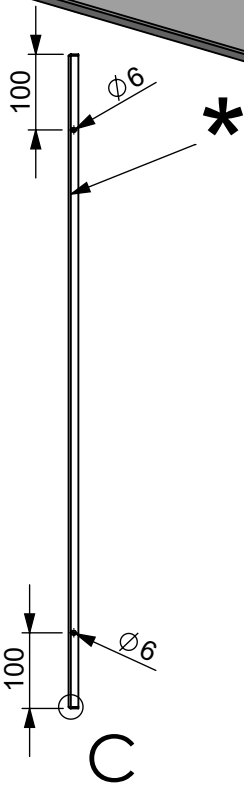
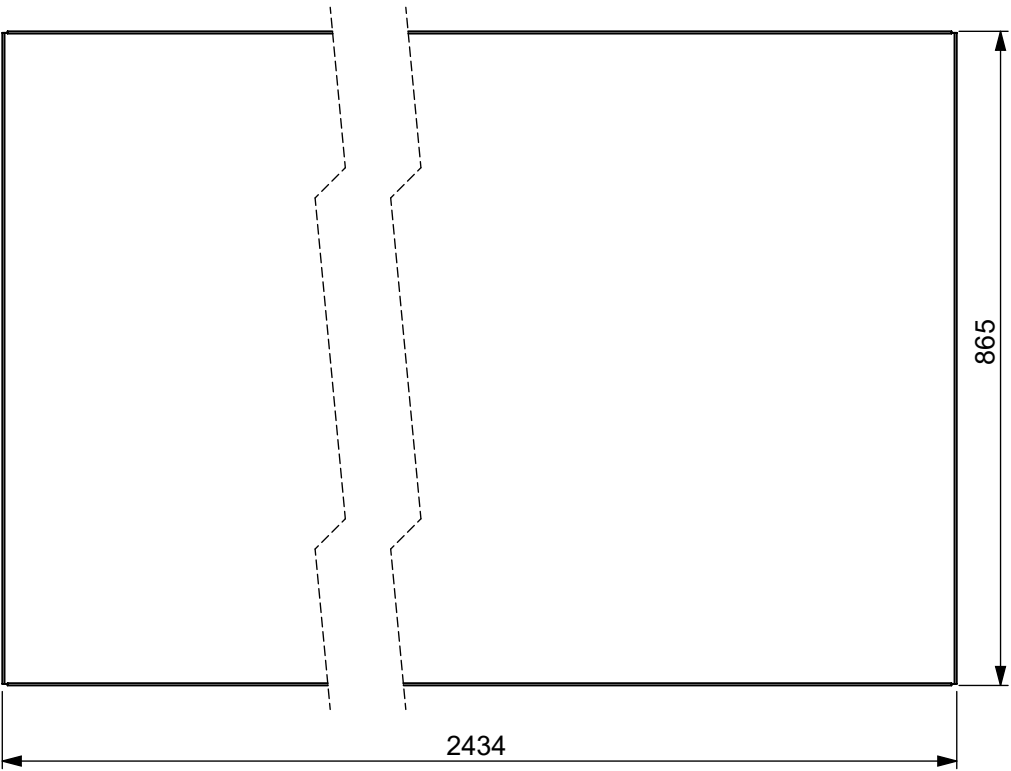

(2) PPC HANGING HOLES

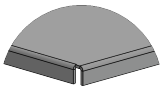

DETAIL D  
SCALE 1 : 5

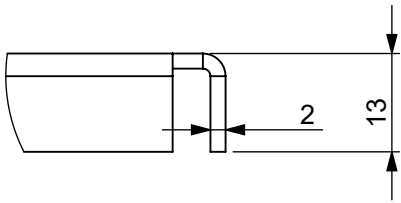
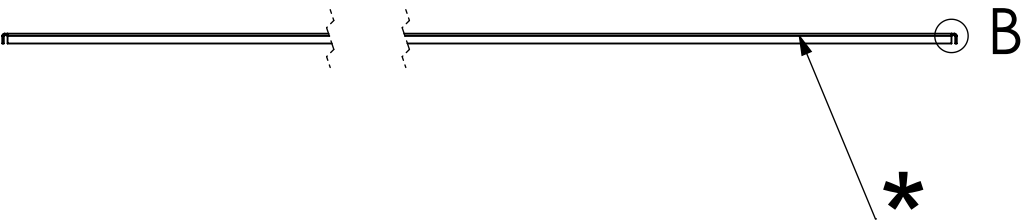

DETAIL B  
SCALE 1 : 1

TOLERANCES	
LINEAR +/-	1mm
ANGULAR +/-	1.0°

ITEM NO.	PART/PUNCH I.D	MATERIAL GRADE	Material Thickness	QTY.
1	CA-90-1100-2.5M SOFFIT	1050A-H14	2	1
		1050A-H14		1

CUSTOMER'S APPROVAL

FULL NAME DD/MM/YYYY SIGNATURE



In association with Skyline Brand

SOR NO.	SOFFIT 2.5M
LINE NO.	CA/90/1100/2.5M
PROJECT:	CANOPY
CUST REF:	CA
SP REF NO.	-

STAGE	DD/MM/YY	INITIALS
CUT		
PUNCH		
BRAKE		
WELD		

FOR PART QUANTITIES, AND REQUIRED FINISH, PLEASE REFER TO WORKS ORDER SOFFIT 2.5M ACCOMPANYING THIS DRAWING

PARTS REQUIRING PPC FINISHES WILL REQUIRE HANGING HOLES, UNLESS SPECIFIED, HANGING HOLES WILL NOT BE POSITIONED WITHIN A 'SHOW' FACE (SHOW FACES INDICATED BY AN ASTERISK "\*\*")

PLEASE NOTE PPC PARTS MAY REQUIRE A HANGING HOLE IN A FACE TO ENABLE PRODUCT TO BE HUNG VERTICALLY THROUGH PPC PLANT

Copyright © 2017 all rights reserved, this drawing is the property of Alumasc Exterior Building Products.

UNLESS OTHERWISE SPECIFIED: DIMENSIONS ARE IN MILLIMETERS

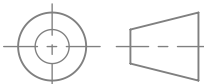

PROJECTION: THIRD ANGLE

DATE:	DESCRIPTION	REV
APPROVED: -	APRV DATE: -	
MATERIAL: 1050A-H14	WEIGHT (KG): 11771.4	
TITLE 1: CA/90/1100/2.5M		REV. A
TITLE 2: SOFFIT		
DRAWN: JC	DATE: 04/02/2021	
SCALE: 1:10 @ A3	SHEET: 1 OF 1	

DWG No.

SOFFIT 2.5M -CA/90/1100/2.5M-A

Designers, including but not limited to, Engineers and Architects, must satisfy themselves in respect of the adequacy of the design provided by Alumasc Water Management Solutions ("Alumasc"). It is the Designer's responsibility to ensure that the data has been correctly interpreted. Alumasc accepts no liability for inadequate or inaccurate designs based on limited or false information supplied by the Designer or misinterpretation of the data supplied. For the avoidance of doubt, designs provided by Alumasc prior to an order being placed are for illustrative purposes only and should not be relied upon save for at the Designer's own risk. Drawings issued by Alumasc in respect of an order after that order has been placed shall be fit for the purpose for which it was created.